



Puretron®

Pure to the last drop

Pure water as well as capture all the finest mind in life

TRIWIN WATERTEC CO.,LTD.

Founded in 1984 in Taiwan,
Triwin fulfills the needs for top quality products
and equipment in the water treatment industry worldwide.



NSF Certified Products

- NSF/ANSI 42 - Drinking Water Treatment Units
- NSF/ANSI 58 - Reverse Osmosis Drinking Water Treatment Systems
- NSF/ANSI 61 - Drinking Water System Components



100% Polypropylene
PP Filter



NSF/ANSI 42 - Drinking Water Treatment Units



• Details Specification,
See Page 41

100% Polypropylene
Grooves PP Filter



NSF/ANSI 42 - Drinking Water Treatment Units



• Details Specification,
See Page 42

Big Blue Filter Housing



NSF/ANSI 42 - Drinking Water Treatment Units



• Details Specification,
See Page 53

Storage Pressure Tank



NSF/ANSI 58 - Reverse Osmosis Drinking
Water Treatment Systems



• Details Specification,
See Page 54

PRESSURE LIMITING VALVE



NSF/ANSI 58 - Reverse Osmosis Drinking Water
Treatment Systems



• Details Specification,
See Page 71

Activated Carbon



NSF/ANSI 61 - Drinking Water System
Components



• Details Specification,
See Page 45

INDEX

- Company Introduction / Factory View 02
- Company Certifications 03

Hydrogen

- Hydrogen Water System 04
- Hydrogen-rich Water bottle 07
- H2 breathe machine 08
- Hydrogen water heating machine 09
- T300 filter-Hydrogen-rich Water 10

RO Water System

- SKRO-Compact RO System 11
- SKDF-Compact RO System 12
- AQ Filter Cartridge for Shark Series 13
- SKEM-Ultrapure water system 14
- ET-PURE 15
- PTRO / PTDF 18
- PLRO 19
- EPRO-AQ / EPRO-ET 20
- MINI-AQ / MINI-ET / MINI-RO 21
- RO-NP / RO-N / RO-AC 22
- U Series RO System 23
- Hummer RO System 24
- Undersink Direct Flow RO system 26
- AQ Series / CTF Series / BB housing 27
- RO / UF Water Purifier 28
- GE Direct Drinking Series 29
- PLUF- Filtration System 30
- 200~500GPD 31
- Desalination System-PT-SD500 32
- Commercial RO system - 800G 33
- Industrial RO system - 1500~9000GPD 34
- 6000~12000GPD 35

Water Dispenser / Water Cooler

- TPH-689 / H-189 36
- TPHC-689 / TPCCH-689 37
- Wall Mounted Water Dispenser TR-5 38
- Touch Panel Type / S-6 39
- Freestanding Water Dispenser S-5 40
- Three-temps Water Dispenser TBR-HWC 41
- Other Water Dispensers 42

Water Dispenser / Water Cooler

- Water Softener 43
- FRP Vessel Tank 44
- Multi-media Filtration System 45
- Control Valves 46
- Distributors 47
- Flow Meter / Tubing 48
- UV Sterilizer 49
- Water Vending Machine 50
- Ozone Generator / Pressure Test Machine 51

Water Dispenser / Water Cooler

- RO pump / Transformer / electric parts 52
- Water Filters-PP NSF (STD) 53
- Water Filters-PP NSF (Grooves) 54
- Water Filter -Pleated Filter 55
- PURETRON Series Filter 56
- ACT-CTO Filter (NSF) 57
- Functional Filter 58
- RO membrane Housing 59
- RO membrane 60
- RO membrane & Filter Cartridges 61
- Filters&Housing 62
- Water Filter Housing- NSF 63
- Water Filter Housing- BB NSF 64
- RO Bracket / RO Tank (NSF) 65
- RO Faucet & Accessories 66
- RO Accessories - Valves 67
- Fittings - Jaco 68
- Fittings- Quick 69
- Other Accessories 70
- Pressure Limiting Valve (NSF) 71
- Mechanical Leakage Detector / Water Hammer 72
- Water Misting System 73

Japan ACF

- Shining Ion Shower 74
- ACF Tap Water Purifier 75
- Portable Water Filter 76
- Straw Water Filter 77

We do care about your water quality.



TRIWIN WATERTEC CO., LTD.,

"Since 1984, TRIWIN has been providing the best products and equipment for the water industry all over the world, including residential, commercial, and industrial RO systems, water purifiers, and all water treatment components. We have professional labs and R&D departments for RTD & testing. Triwin is also a designer and a programmer of basic control systems for our customers. Customers are always our priority. Triwin is delighted to provide private-label products and customized services. "



TRIWIN Company & Factory Verified by BV (Bureau Veritas)

We are very proud to announce that Triwin Watertec is Verified by BV (Bureau Veritas) on-site checking & inspection and to be qualified as a assessed supplier of Water Purifier, Water Filter, Water Dispenser (Water Cooler), Reverse Osmosis System (RO) System manufacturer. Feel free to contact us anytime if any interest of our products.

Assessed Supplier Verified by BV(Bureau Veritas)

We are very proud to announce that Triwin Watertec is Verified by BV (Bureau Veritas) on-site checking & inspection and to be qualified as a assessed supplier of Water Purifier, Water Filter, Water Dispenser (Water Cooler), Reverse Osmosis System (RO) System manufacturer. Welcome to visit our company web site, <http://www.triwin.com.tw>



Hydrogen is a good anti-oxidant substance and is necessary for supporting human life.

Free radicals

Free radicals cause damage to parts of cells by stealing their electrons through a process called oxidation. Oxidation can be harmful to your health.

What are free radicals?

Free radicals are atoms or molecules or ions that contain unpaired electrons. When cells use oxygen to generate energy, free radicals are created in any parts of the human body. These free radicals with unpaired electrons are unstable and they seek to acquire electrons in order to regain stability. When free radicals rob the electrons from other substances, making those substances lose their electrons and become free radicals, a chain reaction ensues. Free radicals are one of causes of diseases and aging. One of the top 10 causes of death is cancer which has been linked to free radicals.

Free radicals can cause age-related diseases or disorders.

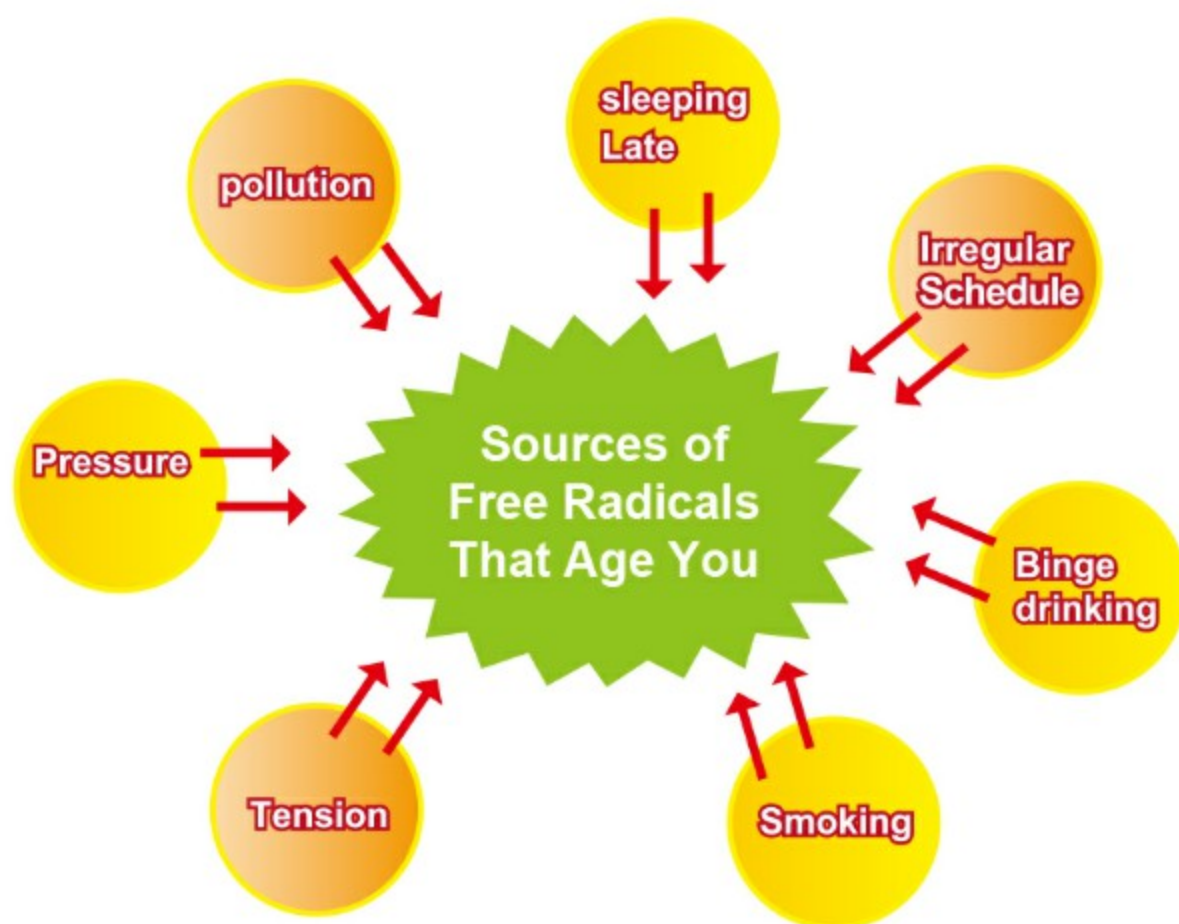

Hydrogen water

Hydrogen water has negative ORP. It is able to donate extra electron and reduce free radicals in the body. That is why we should drink hydrogen water. Molecular hydrogen and reactive oxygen are combined to form water and finally excreted from the body. It is a chemical reaction called "reduction". It might help to decrease risk for age-related diseases. Hydrogen is an element that can prevent oxidation, but not a therapeutic agent. This is not medicine.

Advantages of proton-exchange membrane

Proton-exchange membrane technology (PEM):

- Patented proton exchange technology generates pure hydrogen gas which is dissolved into water.
- Hydrogen water tastes good while it is odorless.
- Power saving, and low energy use.
- No need to clean electrodes; No acid water production.
- No change on the PH value and water quality.
- High concentration of hydrogen which can reached more than 1,000 ppb; Oxidation Reduction Potential (ORP) > -500

Illustration- Hydrogen- Proton Exchange Membrane

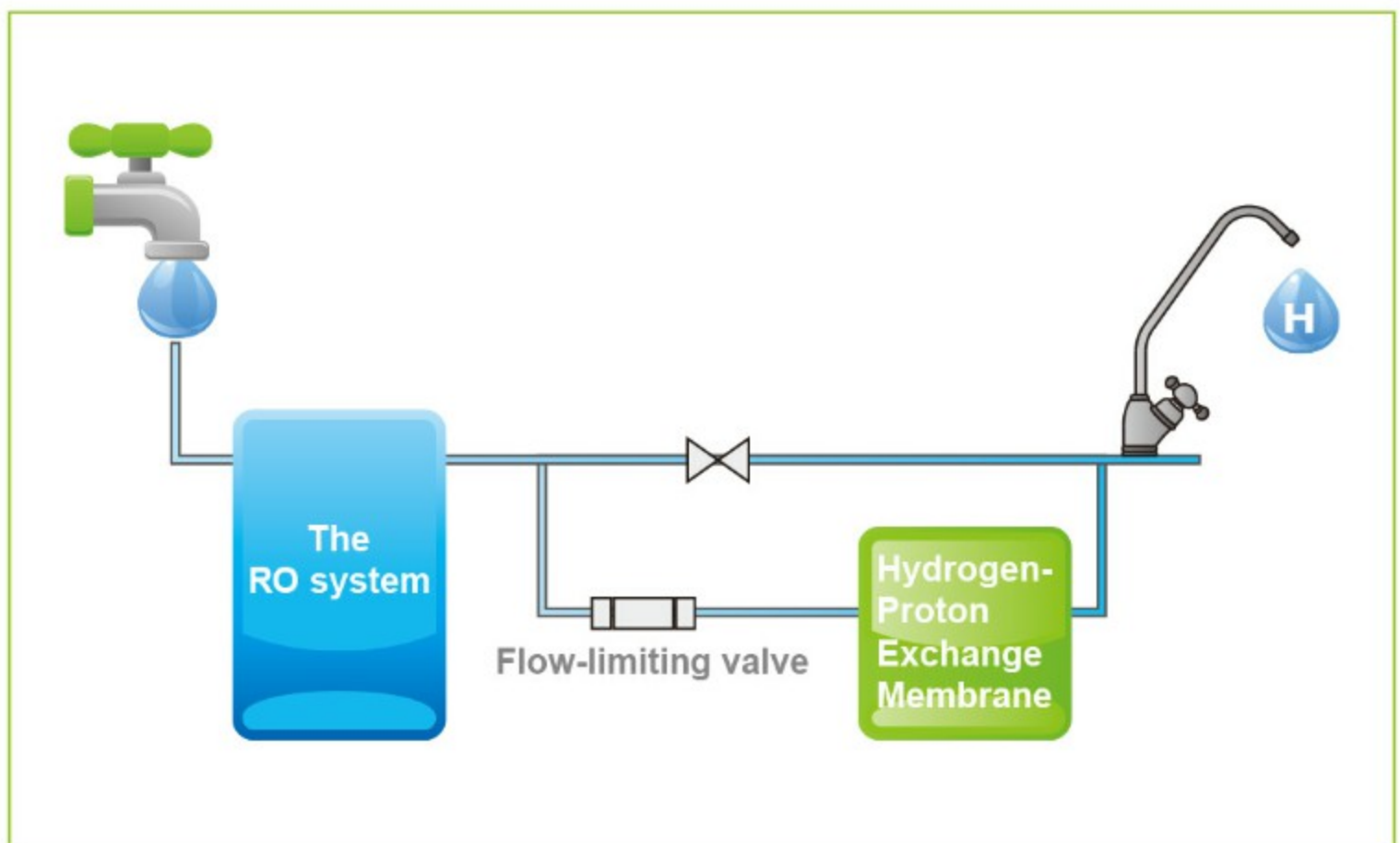

Hydrogen Water System



SKGA Specification: Counter Top (w/ RO system)

Type	Touch Panel Screen
Dimension	W260 x D540 x H470mm
Voltage	AC110~240V
Water Supply	Hydrogen Water
Power	45W(+5%/-10%)
Inlet Temperature	5~40 °C
PH value	Will not change the PH value of Inlet water
ORP	-600±50mV
H ₂	Above1600ppb+10%-5%(by Miz tester)



AQ-1200 Specification: Counter Top (w/ RO system)

Type	Touch Panel Screen
Dimension	W360 x D404 x H460mm
Voltage	AC110~240V
Water supply	Hydrogen Water
Power	45W(+5%/-10%)
Inlet Temperature	5~40°C
PH value	8.14~9.22
ORP	-150±50mV (stay in filter for 5minutes)
H ₂	Average 300ppb(Depends on usage time &Water flow)



H2-PT Specification: Counter Top (w/o RO system)

Type	Push-button
Dimension	W215 x D430 x H397mm
Voltage	AC110~240V
Water supply	Hydrogen Water
Power	52W(±10%)
Inlet Temperature	5~40°C
PH value	Will not change the PH value of Inlet water
ORP	-550±50mV
H ₂	1100ppb+10%-5%



H2-68 Specification: Under Sink (w/o RO system)

Type	Faucet
Dimension	W200 x D200 x H360mm
Voltage	AC110~240V
Water supply	Hydrogen Water
Power	20W(+5%/-10%)
Inlet Temperature	5~40°C
PH value	Will not change the PH value of Inlet water
ORP	-550±50mV
H ₂	1100ppb+10%-5%



The Body of the Cup is Made of Tritan™

Tritan™ is No BPA (Bisphenol A) Components in the Polymerization Process

It Will Not Release of Bisphenol A During the Process of Using.

It Is Your Safest Choice!

The Safest
Tritan™ Material



One Click to Open

Open the Cover by One Hand And Easy to Drink the Water.

Do Not Rebound.



Titanium Platinum Electrolysis Technology

Hydrogen and Oxygen Separation, Efficient Hydrogen Production, Healthy and Environmental Protection.

Using Japanese Batteries, Stable Quality, And High Durability.



USB Charging Port

Hidden Design · Sealed for Waterproof.



Drink hydrogen water and
make yourself healthy and beautiful.

Hydrogen water

	<table> <tr> <td>Model</td><td>H2-SP01W</td></tr> <tr> <td>Capacity</td><td>360ml</td></tr> <tr> <td>Dimension</td><td>Outside Diameter 70±1mm x Height 195mm</td></tr> <tr> <td>Charging Time</td><td>Charge About 3 Hours to Complete</td></tr> <tr> <td>Power Consumption</td><td>5W</td></tr> <tr> <td>Voltage</td><td>5V</td></tr> <tr> <td>Work Times</td><td>5 min/7 times</td></tr> <tr> <td></td><td>It Can Produce Hydrogen about 5000 Times</td></tr> <tr> <td>Battery Life</td><td>It Can Charge 300 Times</td></tr> <tr> <td>Weight</td><td>253 Gram</td></tr> </table>	Model	H2-SP01W	Capacity	360ml	Dimension	Outside Diameter 70±1mm x Height 195mm	Charging Time	Charge About 3 Hours to Complete	Power Consumption	5W	Voltage	5V	Work Times	5 min/7 times		It Can Produce Hydrogen about 5000 Times	Battery Life	It Can Charge 300 Times	Weight	253 Gram
Model	H2-SP01W																				
Capacity	360ml																				
Dimension	Outside Diameter 70±1mm x Height 195mm																				
Charging Time	Charge About 3 Hours to Complete																				
Power Consumption	5W																				
Voltage	5V																				
Work Times	5 min/7 times																				
	It Can Produce Hydrogen about 5000 Times																				
Battery Life	It Can Charge 300 Times																				
Weight	253 Gram																				



The tiny hydrogen molecules have strong reducing power and can selectively neutralize free radicals to bring new strength to the human body.



Helping to sleep
and soothe fatigue



Smooth bowel
movement



Speed Up
Metabolism



Health
Maintenance



Skin
Maintenance

High-Purity hydrogen
99.995%

- Model : H2-HA300 H2 breathe machine with High-Purity hydrogen
- Hydrogen production : Hydrogen and Oxygen separation
- Standard Hydrogen capacity : 300 ml/min \pm 10%
- Control Panel : LCD display and LED light display
- Operation : button-push type
- Attraction : external special nasal straw
- Water source : RO water or Distilled water or Special water that TDS is under ppm.
- Rated voltage : 100V~240V 50/60Hz
- Size : W210*D390*H410mm
- Proper temperature : 5~40°C
- Total power : 140W(+5%/-10%)
- G.W.: 5.3kgs



H2-Pot Hydrogen water heating machine

Multi-purpose machine, priority choose "Puretron"



Warm Hydrogen water
1,200ppb High concentration



Ingesting Pure Hydrogen
99.999%+High-Purity



Light and easy to carry
Satisfy life applications

FEATURE

- Stay close to life anytime, anywhere
- Compact system and large capacity
- Warm light status hint
- Improve texture

Electrolytic Hydrogen EHG & Patented Hydrogen and Oxygen separation



Pure water



>99.999%
High-Purity
Hydrogen water



Microbubble
technology dissolves



High concentration
Hydrogen water

Specification		Hydrogen water heating machine
Model		H2-Pot Hydrogen water heating machine
Feature		Heating to 50°C • High-purity Hydrogen • High concentration Hydrogen water
Capacity		1.8 L
Voltage		AC110V/220V 60Hz
Rated power		200W
Hydrogen Purity		≥99.999%
Hydrogen water	H2	1.0 - 1.2 ppm *(Hydrogen production time: 15mins)
	ORP value	About -550 mv*
	PH value	No change on PH value
Heating to 50°C		50°C
Hydrogen output		12~15 ml/min
Size		W185*D290*H330mm
G.W.:		3kgs.
Safety regulations		No by-products (Hypochlorous Acid and Ozone)

*Hydrogen water concentration and redox potential may differ depending on conditions such as added water quality and ambient temperature.

EHG Technical principle

After the pure water enters the electrolytic plate, it is separated into a hydrogen atom (H) and an oxygen atom (O). The oxygen atom is generated at the anode and is discharged as oxygen. The hydrogen atom is generated at the cathode and polymerized into hydrogen (Purity ≥ 99.999%)

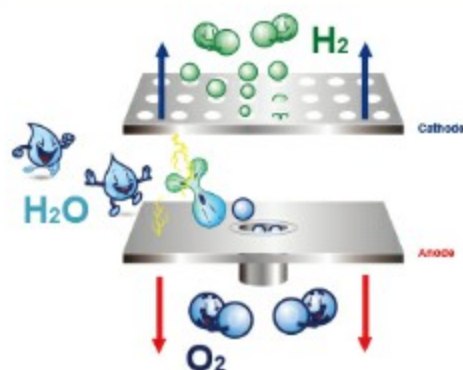

The production of Hydrogen water comes from mineral activity

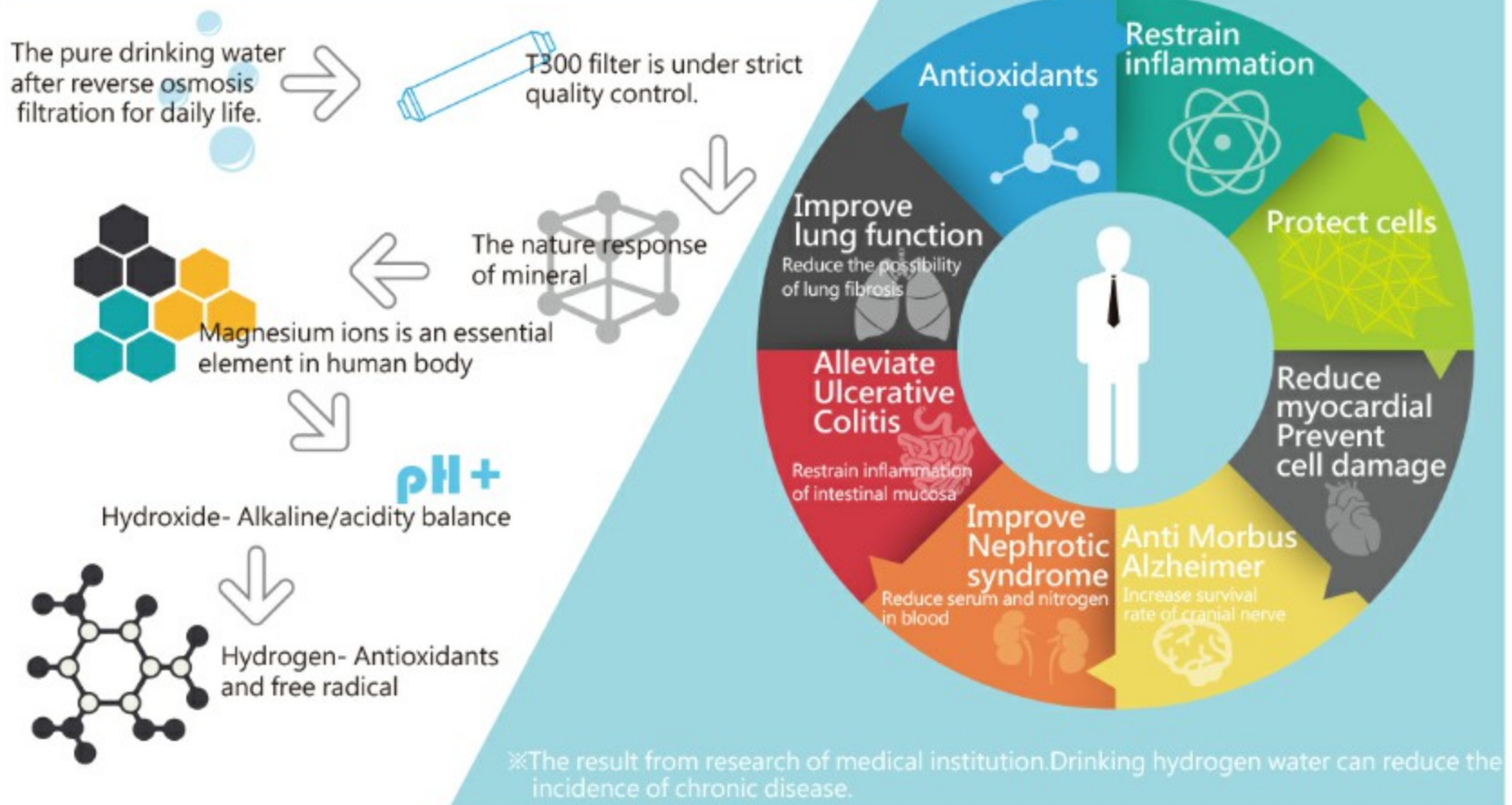

Advantages:

The medical research indicates that **hydrogen** molecular is anti oxidant, which can effectively remove free radical. The hydrogen molecular is considered as an antioxidant of Green Environmental Protection due to its nature feature and without side effect.

Magnesium(The main component of T300)

plays an important role in maintaining healthy. It is the necessary mineral of activity of enzyme in human body, e.g, heart rhythm, constitution of bone, nutrient absorption, and blood sugar regulation. Lack of Magnesium may cause chronic disease, such as osteoporosis, diabetes, and cardiovascular disease.

Thus, Magnesium is a necessary element of healthy food.



※ U.S.FDA No.16328666872





Model No.: SKRO

Characteristic

Puretron® • Logo Display



• LCD Temperature Display



• Water Outlet



• Filter Change Notice



RO

• RO



• Flushing

UV

• UV



• Water Shortage



• Water Full



• Leaking Detector

- Smart Constantly Water Dispensing
- Power Saving Setting(Eco)
- New Touch Panel LCD Screen Design

- Built-in NSF storage tank
- With NSF Tube
- Quick Change Filter Cartridge Design

Specification: -----Counter Top model

1st Stage	Quick Change 5 Micron Spun PP Filter
2nd Stage	Quick Change GAC Carbon Filter
3rd Stage	Quick Change CTO Carbon Block Filter
4th Stage	RO Membrane: 50 / 75 GPD upon request
5th Stage	In-line Post Carbon Filter
Option	UV Sterilizer 1GPM / UF Membrane
Equipped with	Built-in RO-120 8L tank (NSF) Pump & Transformer, Solenoid valve, Flushing valve, TDS sensor Installation Kits included
Unit Dimension	D 540mm x W 260mm x H 480mm





Smart Touch  Innovation

Model No.: SKDF

Characteristic

Puretron • Logo Display



• LCD Temperature Display



• Water Outlet



• Filter Change Notice



RO

• RO



• Flushing

UV

• UV



• Water Shortage



• Water Full



• Leaking Detector

- Smart Constantly Water Dispensing
- Power Saving Setting(Eco)
- New Touch Panel LCD Screen Design

- Built-in NSF storage tank
- With NSF Tube
- Quick Change Filter Cartridge Design

Specification: -----Counter Top model

1st Stage	Quick Change 5 Micron Spun PP Filter
2nd Stage	Quick Change GAC Carbon Filter
3rd Stage	Quick Change CTO Carbon Block Filter
4th Stage	RO Membrane: 500 GPD upon request
5th Stage	In-line Post Carbon Filter
Option	UV Sterilizer 1GPM / UF Membrane
Equipped with	Pump & Transformer, Solenoid valve, Flushing valve, TDS sensor Installation Kits included
Unit Dimension	D 540mm x W 260mm x H 480mm



New Quick Change Water Filter Cartridge

AQ Filter Cartridge for Shark Series

Features:

- Unique Design, Elegant Appearance
- Easy DIY, Quick Change Filter Cartridge
- Auto Shut-Off Water Drop from Filter Cap
- All Quick Fitting Connection

Unique Design:

Housing cap automatically shut off water from 2 ends when open.



Quick Change AQ-RO membrane



Quick Change AQ-Type Filter Cartridge

Inside View:



Specification: -----Counter Top model

Part no.	Filter Types
AQ-P05	Quick Change PP 5 micron Filter
AQ-GAC	Quick Change GAC (UDF) Filter
AQ-CTO	Quick Change Carbon Block CTO Filter
AQ-RO	Quick Change RO membrane 50GPD / 75GPD

Option:

1. Simple Filter Cap without auto shut-off water drop design
2. RO membrane 50GPD / 75GPD upon request

AQ-Type



AQ-RO





- *Simple and flexible operation*
- *Flexibility and economic integration design*
- *Easy maintenance*

Functional Introduction:

- Assure the water quality can reach 18.2Ω.cm
- This machine is combined smart "Touch Panel"
- Water shortage shut down (standby condition)
- Full water shut down (standby condition)
- Leak detection shut down (standby condition)
- Pure water quality auto detection and display
- Ultrapure water system quality auto detection and display
- Auto flushing by flushing valve equipped
- Auto light flashing reminding when filters, RO membrane need to be replaced
- Touch-panel for water out can turn on and off immediately when you touch panel and also can make water out for one minute continually.
- Insufficient expansion hole for water storage tank that can increase the water storage
- External switch for water out continually
- External switch for inner loop

System specifications:

Scale : W260 x D540 x H470mm

Caliber :

Water inlet 1/4"

Waste outlet 1/4"

Water outlet 1/4"

To Pressure tank 1/4"

RO membrane : ULP-2012-100

Operation pressure : 60~80psi

Capacity : 100GPD

System Controller : EC430

Flow Restrictor : PFR400T

Host Motor : P-135 x1

Recycle Motor : P-135 x1

Prefiltration :

AQ-P05 x1 (PP filter)

AQ-CTO x1 (CTO filter)

Solenoid valve :

Diaphragm type x1

DC24V 1/4" quick type x3

Post filters :

nuclear level resin x3 (effective filtration volume about 1T~1.2T)



• Ultrapure water for labs using of electronics industry



• Ultrapure Water for schools' labs



• Equipment manufacturers



• Food medicine researching units

Multi-Function for Indoor & Outdoor

- **Easy Open:**
Automatically Shut-Off Pump



- **Big Cap Design:** Easy Clean



- **Easy Carry to Use Anywhere**



- **Office Usage:**
Change Cap to Funnel
for bottled water dispenser



- **Outdoor Usage:**
DC12V System: Available for Car Camping

- **Patents: for Many Countries**

Taiwan patent no. 199653

U.S.A. patent no. 6872306

China patent no. ZL 01270594.2

Thailand patent no.0203001121

Korean patent no. 0301446



Pure RO water System Widely Application for Home:

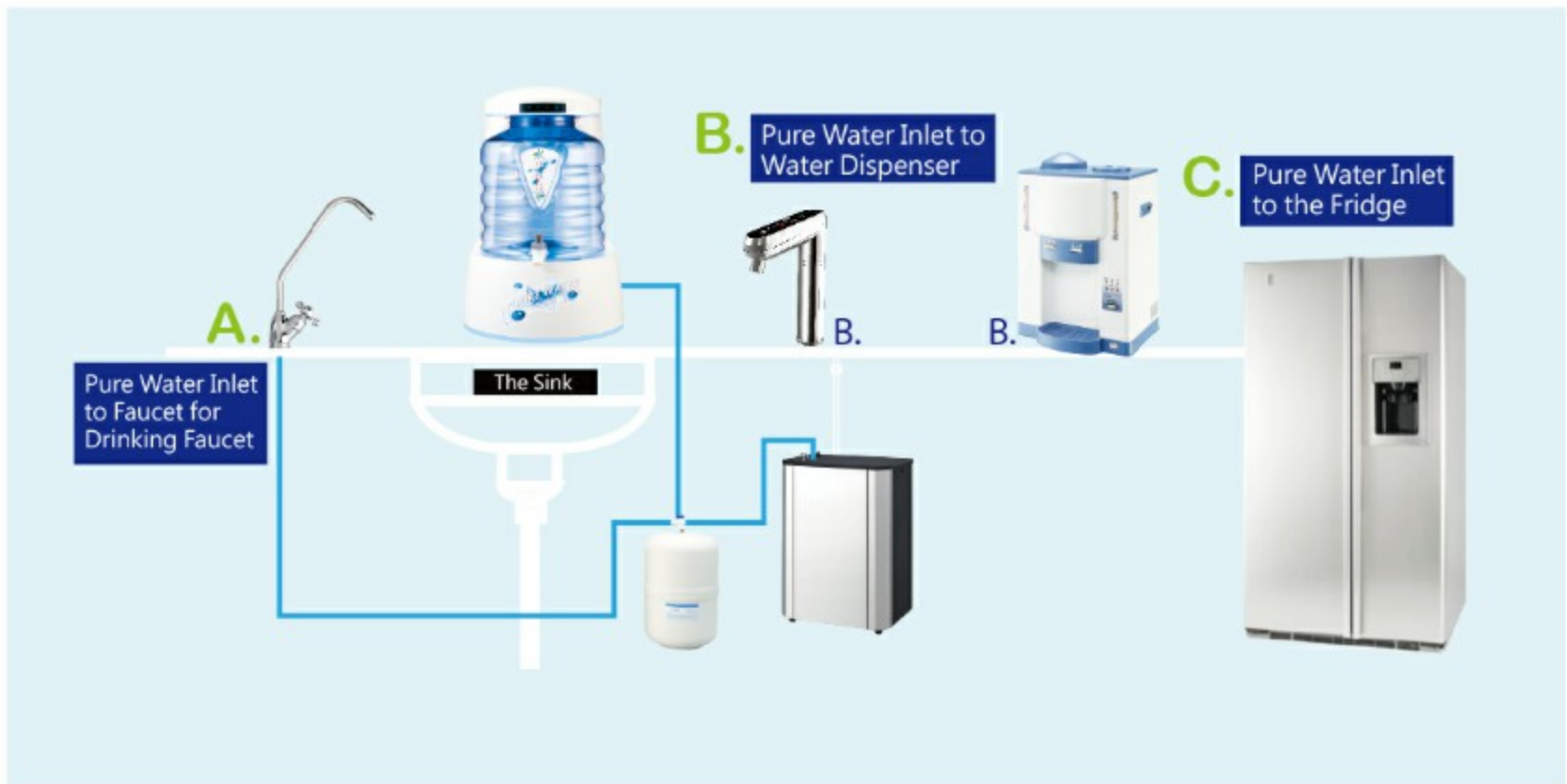

• New Features:

1. LED Lighting Indicator



2. Filter Change Notice



3. Auto-flushing Function



4. Water Leaking Detector



Specification

- 1st Stage 10" Pre-filter Spun PP 5 Micron Filter (Series ET)
- 2nd Stage 10" GAC Carbon Filter(Series ET)
- 3rd Stage 10" CTO Carbon Block Filter(Series ET)
- 4th Stage TFM Membrane: 50/75GPD
- 5th Stage In-line Post Carbon Filter

LED indicator (Power / Work / Empty / Full)
 Storage tank: 2.5 gallons portable storage tank
 Pump 110/220V on request, with 24V transformer
 Faucet & installation kit included
 No tools required (unscrew) & easy for maintenance
 Dimension: D35xW49xH51cm
 Weight: 14kgs

Exploded View

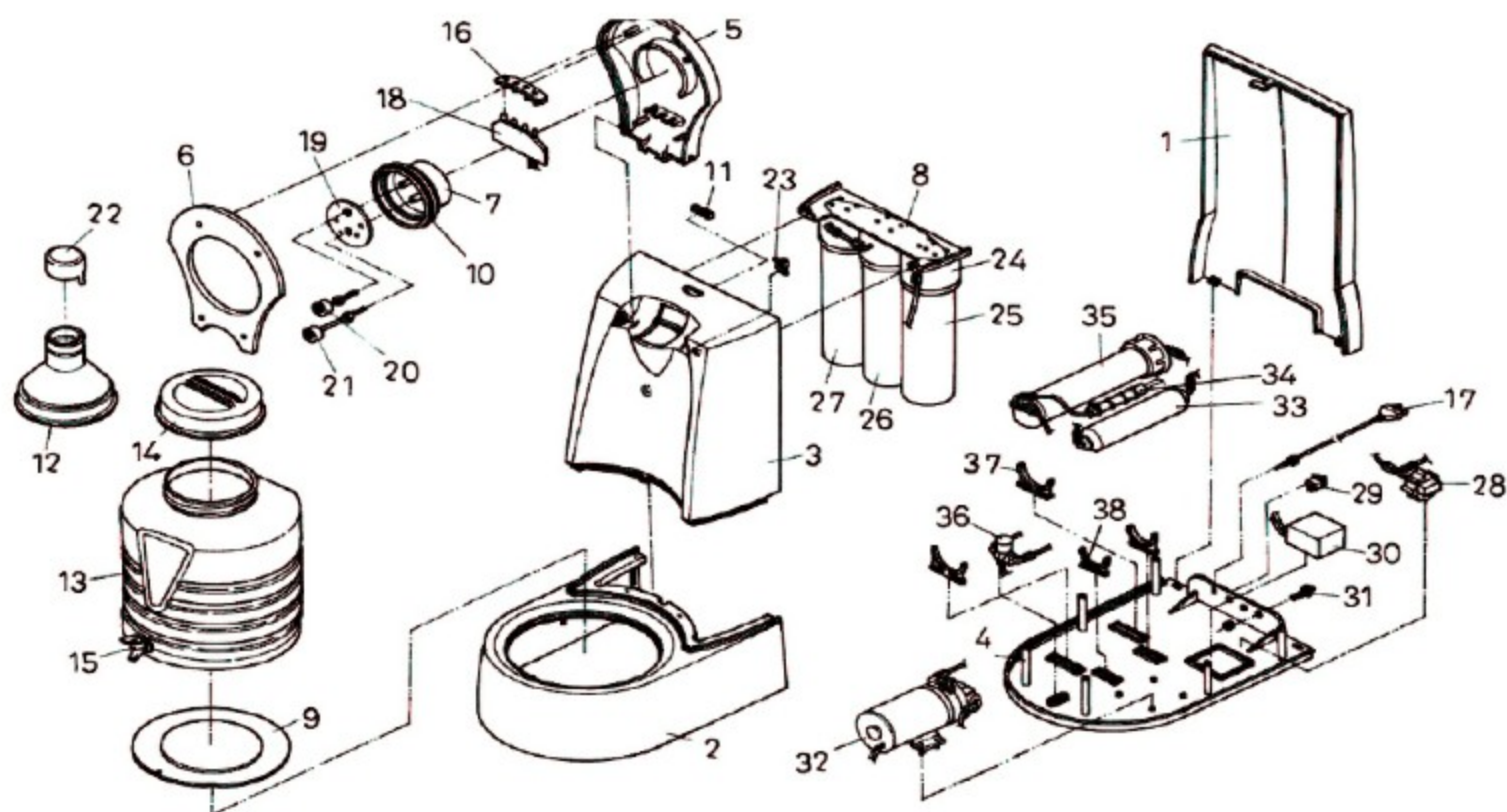

Parts List

Code	Description	item no.	Code	Description	item no.
1	Rear Cover	O005-00AA	20	2" Ball Sensor	O003
2	Main Body	O006-00AA	21	3" Ball Sensor	O004
3	Rear Base	O007-00AA	22	Funnel Cap	O040-001-01AA
4	Base	O008-00AA	23	Precision Switch	O001
5	Upper Cap	O009-00AA	24	Filter Housing Upper Cover	O017-001-01AA01
6	Bottom Cap	O010-00AA	25	Series ET Spun PP 5u, 10"	O030-00-00AA
7	Water Flow Distributor	O011	26	Series ET GAC Carbon, 10"	O031-00-00AA
8	Housing Bracket	O012	27	Series ET CTO Carbon Block, 10"	O032-00-00AA
9	Tank Holder	O013-00AA	28	Low Pressure Switch LP-1000	P0153-02-01AA
10	O-ring	O014	29	Power Switch 1BB	O002
11	Tube Bracket	O015	30	Adaptor	O043-02
12	Funnel	O016-000-01AA	31	FITTING, UNION 1/4" T*1/4" T, QUICK JOINT (4BU4)	O028-01-00AA
13	2.5G PET Tank	O016-01-00BB	32	RO PUMP 24V 1.2A P-135	E0258-12-303-02AB
14	PET Tank Cap	O016-02	33	In-Line Post Carbon, 10"	G0138-08-01AH
15	Plastic Spigot For PET Tank (Blue/ Grey)	O016-03-01	34	Flow Restrictor, jaco type 450c.c.	K0024-01-1
16	Circuit Board Cover	O016-04	35	RO membrane housing	H0007
17	Power Cord	O051-02	36	Solenoid Valve GC-DC24V 1/4"	B0019-02-3
18	Circuit Board	O029	37	2-1/2" Membrane Housing Clip	K0017-02
19	O-ring Bracket	O014-01	38	2" In-line Filter Clip	K0020-01

Features:

- LCD Display with filter change notice
- IC Controller with auto flushing function
- NSF Certified sediment PP filter media
- NSF Certified activated carbon media
- Leaking detector
- No tool required, easy maintenance



Undersink model

PTRO Residential RO System

Model No.	Counter Top model# PTRO-U50/75/100 GPD Undersink model # PTRO-D50/75/100 GPD
Specification	1st stage Quick Change 5 micron PP Filter 2nd stage Quick Change Activated Carbon Filter 3rd stage Quick Change 1 micron PP Filter 4th stage 50GPD / 75GPD / 100GPD membrane) 5th stage Inline Post Carbon Filter Equipped with pump & transformer ceramic faucet, 2L x 2pcs pressure tanks inside Option: UV sterilizer 1GPM or In-line Mineral Filter Unit Dimensions: (D) 50 x (W)29 x (H) 53 cm



Counter Top model

PTDF Direct Flow RO Series

- New Economy Model, 540GPD Direct Flow (Free Flow) RO System
- Small Size, Big Capacity
- With high flow RO booster pump P-600

Model No.	Counter Top model# PTDF-U540 Undersink model # PTDF-D540
Specification	1st stage Quick Change 5 micron PP Filter 2nd stage Quick Change Activated Carbon Filter 3rd stage Quick Change 1 micron PP Filter 4th stage 180GPD x 3pcs (Triwin membrane) Equipped with pump & transformer ceramic faucet, Tankless Unit Dimensions: (L) 38 x (W)21 x (H) 49 cm

Specification:

Model No.	GPD	Description
PTRO-U	50 /75 /100GPD	Counter Top
PTRO-D	50 /75 /100GPD	Under Counter
PTDF-U540	180GPD x 3pcs	Counter Top
PTDF-D540	180GPD x 3pcs	Under Counter

Residential 5 stages RO System with 2L x 2pcs pressure tanks

Direct Flow 4 stage RO System, tankless

PLRO



Features:

- Unique Shape Design
- Compact Size, Save Space
- NSF Certified sediment PP filter media
- NSF Certified activated carbon media
- Under Sink Model with different required filter types
- No tool required, easy maintenance



Residential RO System

Model No.

PLRO

Specification

1st stage Quick Change 5 micron PP Filter
 2nd stage Quick Change Activated Carbon Filter
 3rd stage Quick Change 1 micron PP Filter
 4th stage 50 / 75 / 100GPD RO membrane
 5th stage Inline Post Carbon Filter
 Equipped with pump & transformer
 ceramic faucet, storage tank
 Unit Dimensions: (D) 35 x (W)26 x (H) 46 cm



Specification:

Model No.	GPD	Description
PLRO	50 / 75 / 100 GPD	Under Sink Residential 5 stages RO System with storage tank

EPRO-AQ



Model No.

EPRO-AQ

Specification



- 1st Stage 10" Pre-filter Spun PP 5 Micron Filter
- 2nd Stage 10" GAC Carbon Filter
- 3rd Stage 10" CTO Carbon Block Filter (AQ-Quick change)
- 4th Stage RO Membrane: 50/75/100 GPD
- 5th Stage In-line Post Carbon Filter
- Storage tank: 3.2 gallons steel tank or 5 gallons plastic tank
- Pump 110/220V on request, with 24V transformer
- Faucet & installation kit included
- All quick fitting
- No tools required (unscrew) & easy for maintenance
- Dimensions: (D) 33.5 x (W)22 x (H) 37.5 cm
- Option :
- * 1 GPM UV Lamp / Bio-ceramic / Mineralized filter is available for 6th stage.

Specification:

Model No.	GPD	Description	
EPRO-AQ	50/75/100 GPD	Under Sink	Residential 5 stages RO System with storage tank

EPRO-ET



Model No.

EPRO-ET

Specification



- 1st Stage 10" Pre-filter Spun PP 5 Micron Filter
- 2nd Stage 10" GAC Carbon Filter
- 3rd Stage 10" CTO Carbon Block Filter (ET series)
- 4th Stage RO Membrane: 50/75/100 GPD
- 5th Stage In-line Post Carbon Filter
- Storage tank: 3.2 gallons steel tank or 5 gallons plastic tank
- Pump 110/220V on request, with 24V transformer
- Faucet & installation kit included
- All quick fitting
- No tools required (unscrew) & easy for maintenance
- Dimensions: (D) 33.5 x (W)22 x (H) 37.5 cm
- Option :
- * 1 GPM UV Lamp / Bio-ceramic / Mineralized filter is available for 6th stage.

Specification:

Model No.	GPD	Description	
EPRO-ET	50/75/100 GPD	Under Sink	Residential 5 stages RO System with storage tank

MINI-AQ



Model No.

MINI-AQ

Specification

- 1st Stage 10" Pre-filter Spun PP 5 Micron Filter
 - 2nd Stage 10" GAC Carbon Filter
 - 3rd Stage 10" CTO Carbon Block Filter (AQ-Quick change)
 - 4th Stage RO Membrane: 50/75/100 GPD
 - 5th Stage In-line Post Carbon Filter
- Storage tank: 3.2 gallons steel tank or 5 gallons plastic tank
 Pump 110/220V on request, with 24V transformer
 Faucet & installation kit included
 All quick fitting
 No tools required (unscrew) & easy for maintenance
 Dimension: D21*W50*H52cm
 Option :
 * 1 GPM UV Lamp / Bio-ceramic / Mineralized filter is available for 6th stage.

MINI-ET



Model No.

MINI-ET

Specification

- 1st Stage 10" Pre-filter Spun PP 5 Micron Filter
 - 2nd Stage 10" GAC Carbon Filter
 - 3rd Stage 10" CTO Carbon Block Filter (ET series)
 - 4th Stage RO Membrane: 50/75/100 GPD
 - 5th Stage In-line Post Carbon Filter
- Storage tank: 3.2 gallons steel tank or 5 gallons plastic tank
 Pump 110/220V on request, with 24V transformer
 Faucet & installation kit included
 All quick fitting
 No tools required (unscrew) & easy for maintenance
 Dimension: D21*W50*H52cm
 Option :
 * 1 GPM UV Lamp / Bio-ceramic / Mineralized filter is available for 6th stage.

MINI-RO



Model No.

MINI-RO

Specification

- 1st Stage 10" Pre-filter Spun PP 5 Micron Filter
 - 2nd Stage 10" GAC Carbon Filter
 - 3rd Stage 10" In-line PP 5 Micron Filter
 - 4th Stage RO Membrane: 50/75/100 GPD
 - 5th Stage In-line Post Carbon Filter
- Storage tank: 3.2 gallons steel tank or 5 gallons plastic tank
 Pump 110/220V on request, with 24V transformer
 Faucet & installation kit included
 All quick fitting
 No tools required (unscrew) & easy for maintenance
 Dimension: D21*W50*H52cm
 Option :
 * 1 GPM UV Lamp / Bio-ceramic / Mineralized filter is available for 6th stage

RO System

Residential RO Water System

CAP RO



Stand RO



Model No.

Specification

CAP RO / Stand RO

- 1st stage 10" Pre-filter Spun PP 5 Micron Filter
- 2nd stage 10"GAC Carbon filter
- 3rd stage 10" Sediment Spun PP 1 Micron Filter
- 4th stage TFC Membrane 50/75/100 GPD
- 5th stage Post Carbon filter

Storage tank: 3.2 gallons steel or plastic tank

4 way shut-off valve or solenoid valve

High pressure switch & Low pressure switch

Flow restrictor & check valve

Faucet & installation kit included

Jaco fitting

Pump 110/220V on request, with 24V transformer

Option :

* Micron-computer controller

* 1 GPM UV lamp / Bio-ceramic / Mineralized filter is available for 6th stage.

TWRO Traditional RO System

RO-NP



RO-N



RO-AC



Model No.

Specification

RO-NP / RO-N / RO-AC

- 1st stage 10" Pre-filter Spun PP 5 Micron Filter
- 2nd stage 10"GAC Carbon filter
- 3rd stage 10" Sediment Spun PP 1 Micron Filter
- 4th stage TFC Membrane 50/75/100 GPD
- 5th stage Post Carbon filter

Storage tank: 3.2 gallons steel or plastic tank

4 way shut-off valve or solenoid valve

High pressure switch & Low pressure switch

Flow restrictor & check valve

Faucet & installation kit included

Jaco fitting

Pump 110/220V on request, with 24V transformer

Option :

* Micron-computer controller

* 1 GPM UV lamp / Bio-ceramic / Mineralized filter is available for 6th stage.



Specification:

Model No.	GPD		Description	
RO-NP	50/75/100	Under Sink	5 stages filters	4 way shut-off valve w/o pump
RO-N				4 way shut-off valve w/pump
RO-AC				Solenoid valve w/ pump&AC BOX

Traditional RO System



5 Stages filters

- 1st stage 10" disposable 5 Micron Pre-filter PP Filter
- 2nd stage 10" disposable GAC Carbon filter /CTO Carbon Block Filter
- 3rd stage 10" disposable sediment 1 Micron PP Filter
- 4th stage TFM Membrane 50/75/100 GPD
- 5th stage in-line Post Carbon filter

✧ Also have options for 9" housing.

Specifications

Storage tank: 3.2 gallons steel or plastic tank
High pressure switch & Low pressure switch
Faucet & installation kit included
All quick fitting
No tools required (unscrew) & easy for maintenance
Pump 110/220V on request, with 24V transformer
Dimension: D21xW50xH52cm
Weight: 8/12kgs

N-Series filter (Replaced filter)

NAP-9 Series



Anti-Bacterial
5micron

NPP-9 Series



PP 5Micron

NGAC-9 Series



GAC

NCTO-9 Series



CTO

N-R-9 Series



RESIN

Hummer Reverse Osmosis System

HMRO



- Elegant design ; Unique idea!
- High filtration performance.
- Nanometer RO membrane removes heavy metal and Carcinogen.
- The addition of mineral improves our body health.
- Space save 25%
- 100% manufacture in Taiwan with high stable quality.
- Power saving system.
- Anti-dust, anti-cockroach, and anti-bacteria on whole system.

One year warranty from the shipping date. Any damage caused by misuse of users shall not be covered by the warranty hereof.

Specification



Hummer Reverse Osmosis System

Model No.	HM-050 / HM-075 / HM-100
Type	Mechanical Tap
Dimension	W174xD330xH450mm
Complex filter	PP/CTO . 2000G
RO Membrane	50G / 75G / 100G
Operating pressure	85psi
Voltage	110V / 220V common use
Pressure tank	3.2G (NSF)

Replace filter easily!

No tools.



1. Twist the housing clockwise



2. Take off the black clip



3. After tightening the housing counterclockwise, take the housing apart from upper cap



4. After replacing the RO membrane, reinstall the housing counterclockwise, and then put the black clip back in place.

HUMMER RO WATER SYSTEM

Filter Cartridge

1st stage PP filter-

Removes microorganism, solid sediment such as rust, silt, dirt and sand..etc.

Replacement:

Service life depends on water consumption. To replace every 6 months is recommended.

3rd stage aerospace technology RO membrane-

Fully removes heavy metal such as Arsenic, Cobalt, Cadmium, Mercury, bacteria, and virus to supply safety drinking water (common use- Ground water and tap water)

Replacement:

Service life depends on water consumption. To replace every 2 year is recommended.

2nd stage High quality coconut shell activated carbon-

Removes chlorine, taste, rust..etc.

Replacement:

Service life depends on water consumption. To replace every 6 months is recommended.



4th stage post activated carbon filter-

High density activated carbon filter removes remaining chlorine and tastes. No worry about second pollution issue, and will improve the water taste.

Replacement:

Service life depends on water consumption. To replace every year is recommended.

Complex Filter meets the standard of NSF



Hammer Undersink Direct Flow RO system

HM-500



- Elegant design ; Unique idea!
- High filtration performance.
- Nanometer RO membrane removes heavy metal and Carcinogen.
- The addition of mineral improves our body health.
- Space save 25%
- 100% manufacture in Taiwan with high stable quality.
- Power saving system.
- Anti-dust, anti-cockroach, and anti-bacteria on whole system.



Specification

Model No.	HM-500
Type	Mechanical Tap
Dimension	W174xD430xH450mm
Complex filter	PP/CTO . 2000G
RO Membrane	500 G
Pure water flow rate	1500cc/min
Operating pressure	65psi
Voltage	110V / 220V common use
Pressure tank	No Tank

TWRO Undersink Direct Flow RO System

TWRO



- 300GPD RO membrane x1pc / 500GPD RO membrane x1pc
- With high flow RO booster pump

1st stage NSF certified PURETRON 5 Micron PP Sediment Filter
2nd stage PURETRON carbon media, Carbon Block Filter
3rd stage NSF certified PURETRON1 Micron PP Filter
4th stage 300/500GPD RO membrane
5th stage Post carbon filter
6th stage:
UV lamp 1GPM / 10" in-line BIO ceramic filter
/ 10" in-line Mineralize filter (Option)

- With ceramic faucet
- With installation kits
- Dimension: L38x W21x H49cm

FILTRATION SYSTEM

AQ Series

TYPE : Quick Change

You can decide the most suitable filters to meet your needs on AQ filtration system. We are available to supply from one stage, two stages, three stages and to four stages.



Specifications

- AQ Quick fitting PP 5u filter
- AQ Quick fitting GAC filter
- AQ Quick fitting CTO filter
- AQ Quick fitting Resin filter
- AQ Quick fitting UF membrane
- AQ Quick fitting RO membrane 50G

Specifications

CTF-1 Single stage

1st Stage 2 in 1 filter (PP 5 Micron+GAC filter)

CTF-2 Single stage

1st Stage 2 in 1 filter (PP 5 Micron+GAC filter)

2nd Stage CTO Carbon block filter

CTF-3 Single stage

1st Stage 2 in 1 filter (PP 5 Micron+GAC filter)

2nd Stage GAC filter

3rd Stage CTO Carbon block filter

Part no	CTF-1	CTF-2	CTF-3
Dimension	15.5x13.5x32cm	16.5x26x32cm	16.5x39x32cm
Weight	2.0kgs	4.0kgs	6.0kgs

CTF Series

TYPE: Counter Top

CTF-1



CTF-2



CTF-3



BB housing

Pure Water from Compact RO system



2H-20BB



3H-20BB

2H-20BB

Housing:

Big blue type 20" Rib, w/pressure release 1" NPT

Filters:

1st stage : 20" Pre-filter Spun PP 1 Micron Filter

2nd stage: 20" GAC Carbon Filter

3H-20BB

Housing:

Big blue type 20" Rib, w/pressure release 1" NPT

Filters:

1st stage : 20" Pre-filter Spun PP 1 Micron Filter

2nd stage: 20" GAC Carbon Filter

3rd stage: 20" CTO Carbon Block Filter

Option: UV lamp 6 GPM

RO Water Purifier

Characteristic

Easy DIY
Quick Change Filter Cartridge
Suitable for residential use.
Quick connect fittings , easy connection.

Specification:

1st Stage 10" Pre-filter Spun PP 5 Micron
2nd Stage 10" CTO Carbon Block Filter
3rd Stage 10" RO membrane



UF Water Purifier

Characteristic

Easy DIY
Quick Change Filter Cartridge
Suitable for residential use.
Quick connect fittings ,
easy connection.

Specification:

1st Stage 10" Pre-filter Spun PP 5 Micron
2nd Stage 10" CTO Carbon Block Filter
3rd Stage 10" UF membrane





NSF42、NSF53 certification.

International water purification quality



Two stages filtration system

• PPSu fiber active carbon filter

Remove the large solid sediments, fine sand, sludge, rust, slag, suspended matter, and granule impurities in the water.

• GSBF-1500

Applicable to areas with serious water pollution



Three stages filtration system

• PPSu fiber active carbon filter

• WS-Resin double effect filter

The use of ion exchange resin to exchange calcium, magnesium, and calcareous ions in water, it can improve the taste of hard water and reduce scale formation.

• GSBF-1500

Applicable to areas with serious water pollution

Model	Two stages filtration system	Three stages filtration system
Flow rate	0.6GPM(2.3LPM)	0.6GPM(2.3LPM)
Dimension	W26.5xD16xH41cm	W41xD16xH41cm
Effective treatment of water	2,500 Gallons / 9,463 Liters	2,500 Gallons / 9,463 Liters
Replacement Cartridge Model	GSBF-1500R	GSBF-1500R
Part No.	I0217-18-01AA	I0219-028-01AA

Water Temp.: 4.4~37.8° C / Water pressure: 30~100psi / Filtration accuracy: ≥ 0.5 microns

Water source: Tap water only, suggest replace the filters every 6~12 months.

GE POU



ATS2500 / ATS5000



VIR1500 / VIR3000



VOC3000 / VOC6000

Measurement standard	NSF standard					
Model	ATS5000	ATS2500	VIR3000	VIR1500	VOC6000	VOC3000
Capacity (L)	19,700	9,800	3,800	2,800	11,300	5,700
Flow rate (L/Min)	6.3	6.3	2.3	2.3	3.0	2.0
Dimension	18"	10"	18"	10"	18"	10"
Part No.	I0225-06-AB	I0225-06-AA	I0225-07-AB	I0225-07-AA	I0225-08-AB	I0225-08-AA

TYPE: Under sink/Wall up

6 Stages filters

- 1st Stage 10" Pre-filter Spun PP 5 Micron (Series PT)
- 2nd Stage 10" GAC Carbon Filter (Series PT)
- 3rd Stage 10" Sediment Spun PP 1 Micron (Series PT)
- 4th Stage Bio-ceramic mineral filter
- 5th Stage Ceramic filter
- 6th Stage UF membrane/ UV Lamp 1 GPM

Option

- * **PLUF** : 6th Stage UF membrane
- * **PLUV** : 6th Stage UV Lamp 1 GPM



Specifications

- Faucet & installation kit included
- All quick fitting
- No tools required (no screw) and easy for maintenance
- Dimension: D35xW46.5xH25.5cm

Inside view



200~500GPD

Application:

Commercial & Industrial systems for schools, Apartments, Restaurants

RO-200~RO-500

W / IC controller



Standard Features

- * R.O. membrane auto-flush mode indicator
 - * Digital IC controller
 - * Low pressure switch
 - * High pressure switch
 - * Feed water pressure gauge
 - * Totalizing hour meter
 - * RO Membrane Double O-ring(MH-1812)
 - * Stainless steel R.O. high pressure pump
- Dimension: D28xW45xH81cm

RO-200~RO-500

W / O IC controller



Operating Conditions

- * Maximum feed water temp. 85F
- * Feed water pressure 5-40psi
- * Operating pressure 100psi maximum
- * Feed water TDS 500PPM maximum
- * Hydrogen sulfide must be removed
- * Turbidity must be removed

Part no.	RO output	Filters (1 st stage -3 rd stage)	RO Membrane (4 th stage)	Filters (5 th Stage)
RO-200	200GPD	1 st Stage 20" Pre-filter PP 5micron 2 nd Stage 20" GAC Carbon 3 rd Stage 20" CTO carbon block	100GPD x 2	in-line Post carbon
RO-300	300GPD		100GPD x 3	
RO-400	400GPD		100GPD x 4	
RO-500	500GPD		100GPD x 5	



PT-SD500

Desalination System.



• High pressure electricity cut-off protection



• Pre-filtration filters



• Flow meter and Pressure gauge for inspection



• Connectors with Build-in type



• Electronic control modularization

Specification.

Model	Capacity GPD (m ³ /d)	Rejection rate	Case type	HorsePower	Voltage & Phase
PT-SD200	200 / 0.76	99.2%	Bracket type/Box type	1 HP	110V / 220V 1 Phase or 3 Phase
PT-SD500	500 / 1.89	99.2%	Bracket type/Box type	1 HP	110V / 220V 1 Phase or 3 Phase
PT-SD800	750 / 2.8	99.2%	Bracket type/Box type	1 HP	110V / 220V 1 Phase or 3 Phase
PT-SD1500	1400 / 5.3	99.5%	Bracket type/Box type	3 HP	220V 1 Phase or 3 Phase
PT-SD3000	2800 / 10.6	99.5%	Bracket type	3 HP	220V 1 Phase or 3 Phase

- Please contact with our company for having customizes system if you have other requirements.

Advantages:

- Case appearances: #SS304 2mm powder-paint coating for antirust treatment.
- FRP membrane housing, pressure resistance 1000psi (70kg)
- Safety Device: Pressure can be adjusted; the system will be shutoff when the pressure is overloaded.
- Safety Device: Optional for having fresh water selector valve to avoid to getting sea water.
- Period of Use: Suggest add system to expand longer life-span.
- Warranty: One year from the shipping date under to normal use only. Any damage caused by misuse of users shall not be covered by the warranty hereof.
- Place of Origin: 100% Made in Taiwan.

Applicaton: Commercial R.O. system are applicable to Schools Apartments, Restaurants, Hospitals, Laboratories...etc

L-B 800G



Standard Features:

- TFC membrane
- Stainless steel RO membrane vessels
- 5 Microns sediment filter 20"
- Three carbon block 20"
- Inlet solenoid valve
- Pressure control valve
- Low pressure cut-off
- One high pressure gauge 0-225 psi, Liquid filled
- Two low pressure gagues 0-150 psi, Liquid filled
- Stainless steel frame
- Nylon tubing
- Easy operation
- TDS monitor (optional)

Operating Conditions:

Maximum feed water temp. 85F
 Feed water pressure 40-80psi
 Operating pressure 200psi maximum
 Feed water TDS 500PPM maximum
 Iron tolerance 0.25PPM maximum
 Silica tolerance 25PPM maximum @50% recovery
 pH range 3-11
 Hydrogen sulfide must be removed
 Turbidity must be removed
 Water recovery up to 30%
 Average salt rejection 95%-99%+

Part no.	ROoutput	RO membrane	Inlet Pipe	Motor	Dimension
L-B 800G	800GPD	4.0"x21"x1	3/8"	0.5HP	30x51x103cm

Applicaton: Commercial & Industrial systems for Schools, Apartments, Restaurants

**1500G-M****1500G-N / 3000G-N****6000G-H / 9000G-H**

Part no.	RO output	RO membrane	Inlet Pipe	Motor	Dimension
1500G-M / 1500G-N	1500GPD	4040x1	3/4"	1.0HP	60x60x155cm
3000G-N	3000GPD	4040x2	3/4"	3.0HP	60x60x155cm
6000G-H	6000GPD	4040x4	1"	4.0HP	160x80x135cm
9000G-H	9000GPD	4040x6	1"	4.0HP	160x80x135cm

Standard Features

Stainless steel frame
 TFM membrane
 Stainless steel or FRP RO membrane vessels
 High pressure pump
 Control box
 Power on/off switch
 5 Micron pre-filter 20"
 Product water flow meter
 Low pressure cut-off
 One high pressure gauge 0-225 psi, Liquid filled
 Two low pressure gagues 0-150 psi, Liquid filled
 Automatic flush
 Light vertical multi-step centrifugal pump

Operating Conditions

Operating Conditions:
 Feed water temp. 85F° maximum
 Feed water pressure 35-85psi maximum
 pH range 4-12
 Turbidity must be removed
 Iron: maximum tolerance 0.5PPM (dissolved only)
 Hardness: over 10 gpg should be softened
 Hydrogen sulfide: 98% nominal
 Electrical: 110v,60Hz (50Hz available on request)
 220-440v, 60Hz (50Hz available on request)
 Test conditions: operating pressure 200psi
 design temp. 77F° (25C°)
 membranes: thin film composite (TFC)

R.O.systems are applicable to Hospitals,Laboratories...etc



Part no	RO output	RO membrane	Inlet Pipe	Motor	Dimension
PURO-800	800GPD	4021x1	3/4"	0.5HP	150x60x125cm
PURO-1500	1500GPD	4040x1	3/4"	1.0HP	165x60x165cm
PURO-3000	3000GPD	4040x2	3/4"	1.0HP	155x78x180cm
PURO-6000	6000GPD	4040x4	1"	2.0HP	180x80x180cm
PURO-9000	9000GPD	4040x6	1-1/4"	3.0HP	200x100x175cm
PURO-12000	12000GPD	4040x8	1-1/4"	3.0HP	220x110x175cm

Standard Features

- Powder coated steel frame
- Multi-media filter
- Carbon filter
- Water softener
- TFM membrane
- Stainless steel or FRP RO vessel
- High pressure pump
- Control box
- Power on/off switch
- 5 Micron pre-filter 20"
- Product water flow meter
- High pressure gauge
- Inlet low pressure gauge
- Low pressure switch
- Heavy-duty PVC piping
- Automatic flush
- Vertical multi-step centrifugal pump
- Optional : UV sterilizer and ozone

Operating Conditions

- Feed water temp. 85° F maximum
- Feed water pressure 35-85psi maximum
- pH range 4-12
- Turbidity must be removed
- Iron: maximum tolerance 0.5PPM (dissolved only)
- Hardness: over 10 gpg should be softened
- Hydrogen sulfide must be removed
- Salt rejection:98% nominal
- Electrical: 110v,60Hz (50Hz available on request)
- 220-440v, 60Hz (50Hz available on request)
- Test conditions: operating pressure 200psi
- design temp. 77° F (25°C)
- membrane: thin film composite (TFC)



Features:

Hot Water Temperature 85~100 degree C
Re-boil function
Child Safety Lock
Continuous flow
Stainless steel#304 hot water tanks
Easy operation & maintenance

Enjoy boiling water for making coffee, tea and cooking.



Specification:

Under Counter model

Model# TPH-689

With touch panel faucet

Hot Water Tank: 4L

Watt: 750W

Safety Design overload circuit breaker, fuse

Dimension: W23xD29xH42cm

Specification:

Under Counter model

Model# H-189

With Mechanical Tap

Hot Water Tank: 3L

Watt: 750W

Safety Design overload circuit breaker, fuse

Dimension: W20xD20xH36cm

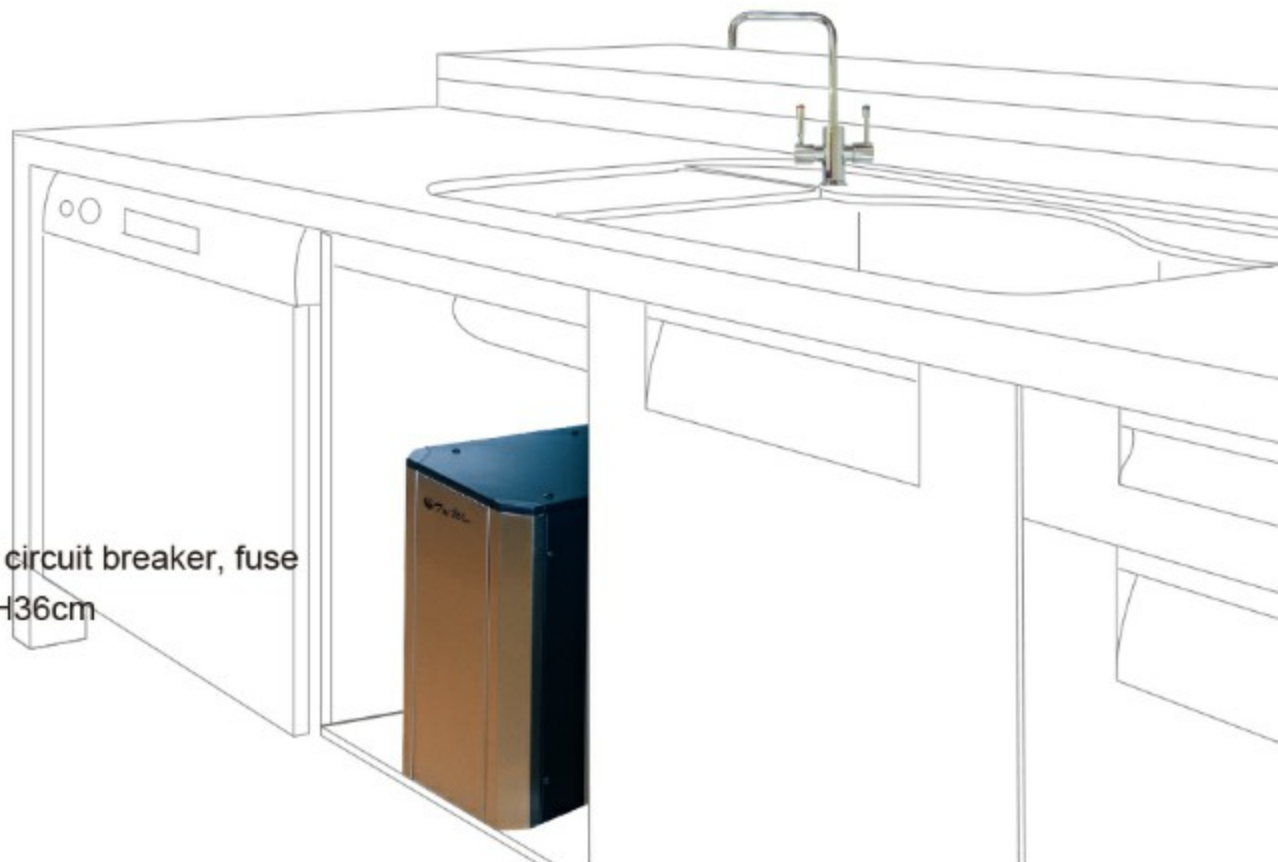

NOTE:

Recommended to equip this unit with water purifier such as Reverse Osmosis System to ensure water quality is suitable for the unit.

Touch Panel Type -Electronic Tap with Under Counter Cold & Hot Water Dispenser



Puretron • Logo Display (POWER ON/OFF)



- LCD Temperature Display
Display current water temperature

- Re-Boil Touch the button to have automatical boil again to reach 100 degree C.



- Child Safety Lock Release the lock before getting hot water, prevent accident from being scald.



- Power Saving Setting
Eco-friendly design, set the unit at sleeping mode when leave office/house



- Hot Water
Dispense hot water



- Ambient Water
Dispense ambient water



- Chilled Water
Dispense chilled water

**** Continuous Flow****

Touch the button once will continuously dispense water for 50 seconds:
If hold the button, the water will stop when button is released

Model No.: TPHC-689 / TPCCH-689

Specification:

Type	Two temp / Three temp	Temperature	Hot Water : 85~100 degree C Chilled Water : 6~12 degree C
Faucet	Touch Panel Tap	Power	110v / 220v available
Temperature	chilled & Hot Water / chilled & Hot & Ambient Water	RO System	Without 5 stage RO or filter system
Case Material	Front cover: S.S.#304	Safety Design	overload circuit breaker, fuse
Power Rating	Hot Water: 750watt Chilled Water : 180watt	Dimension	D 290mm x W 460mm x H 420mm
Tank Capacity	Hot Water : 4L Chilled Water : 2L	**Recommended to equip this unit with water purifier such as Reverse Osmosis System to ensure water quality is suitable for the unit.	

**Features:**

- LCD display
- Re-boil function
- Child Safety Lock
- Continuous flow
- LED Lighting
- Energy Saving Setting
- Temperature Holding Setting
- Stainless steel#304 hot and cold water tanks
- Easy operation & maintenance

Simple, Elegant , Modern, Eco-Friendly

A new concept of lifestyle.

Temperature	chilled / Ambient / Hot Water
Case Material	Front cover: S.S.#304
Hot Water Watt	750watt
Chilled Water Watt	100watt
Hot Water Tank Capacity	5L
Chilled Water Tank Capacity	2.5L
Ambient Water Tank Capacity	10L
Voltage	AC 110V / 220V
Dimension	D 480mm x W 595mm x H 592mm
RO System	Without 5 stage RO or filter system
Safety Design	overload circuit breaker, fuse
Advantages	1. LED lighting 2. Power Saving Setting 3. Temperature Holding Setting 4. Child Safety Lock

Filtration

Recommended to Supplied with external RO system or sub-micron filter to ensure water quality is suitable for the machine

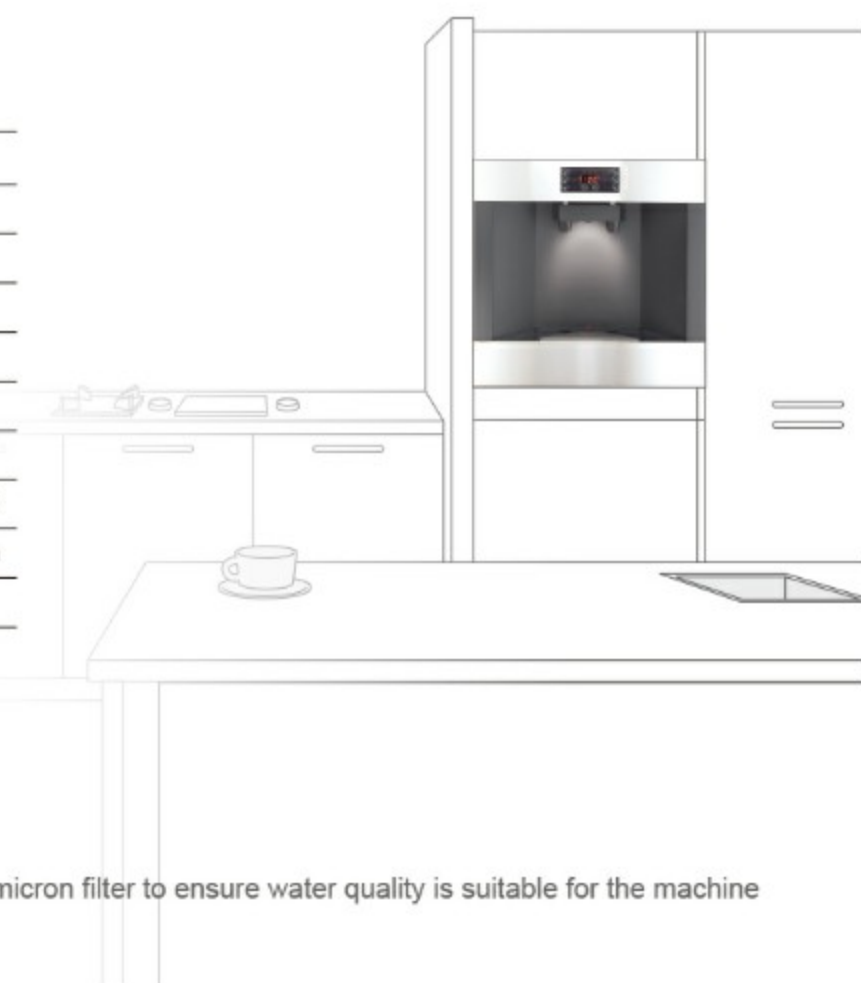

**Specification:**

Model no.	S-6-3H
Temperature	Ice/Warm/Hot
Material	Front cover : S.S.304
Hot Water Watt	1000W
Ice Water Watt	180W
Hot Water Capacity	15L
Ice Water Capacity	3L
Warm Water Capacity	12L
Dimension	D 460mm x W 380mm x H 1350mm
RO System	Built-in 5 stage RO system
Safety	overload circuit breaker,fuse
Advantages	1.Touch panel 2.Power saving setting 3.Temperature holding setting



**Features:**

- LCD display
- Re-boil function
- Child Safety Lock
- Continuous flow
- LED Lighting
- Energy Saving Setting
- Temperature Holding Setting
- Stainless steel#304 hot and cold water tanks
- Easy operation & maintenance



TBR-HWC

Counter top RO built-in plus

Three-temps
water dispenser

Lock Child Safety Lock
 Boil Re-Boil
 Chilled/Boiled/Ambient water
 RO Built-in RO system

Feature:

- Continuous water flow, automatic water filling and heating, and re-boiling system.
- LED digital display panel.
- Built-in RO system has perfect filtration, and saving space.
- With perfect drinking lighting, the water level is clearly displayed.
- The water outlet button is enlarged, and the color is intuitively taken, which is more convenient to use.

Safety design:

- Avoid empty burning design.
- Error code display, accurate to control the system status.
- Child safety lock, boiled water lock to anti-scalding.
- 316 Stainless Steel heating pipe, 304 Stainless Steel water storage tank.
- Attach with leakage circuit breakers and leakage detector.



- ▶ Guided lighting
- ▶ One water outlet to avoid any bacteria



- ▶ Intuitive button design
- ▶ Continuous water flow



- ▶ Temperature display
- ▶ Error code hint

Specification

Model: TBR-HWC counter top water dispenser

Capacity: Chilled water 1.5L / Ambient water 4.5L / Boiled water 1.7L

Dimension: D543xW268xH562mm

Voltage: 110V/220V

Filtration system: built-in RO system

Application: Domestic / Office and so on.

TYPE: Counter-top Water Dispenser



TPHC-689
TPCCH-689



Tri-Polaris



Odyssey counter
(W/Bottle water)



CW-919

TYPE: Free-standing Water Dispenser



TR-5 Series



S-6 Series



Odyssey standing
(W/Bottle water)



CW-929

Remark | RO system is available for above freestanding water dispenser

Part no	Temp-type		Material	Water Tank Volume	Dimension
Tri-Polaris	Three-temp Cold/Warm/Hot		ABS	5liter(cold),1.2liter(hot)	D35xW33.50xH43cm
Odyssey counter (W/Bottle water)	Two-temp	Cold/Hot	ABS	3liter(cold),1liter(hot)	D26xW33xH49cm
Odyssey standing (W/Bottle water)	Two-temp	Cold/Hot	ABS	3liter(cold),1liter(hot)	D26xW33xH110cm
CW-919HW	Two-temp	Hot/Warm	ABS	2 liter(cold),2 liter(warm)	D33xW40xH52cm
CW-919CWH	Three-temp	Cold/Warm/Hot	ABS	10 liter(warm),2 liter(cold),2 liter(hot)	D33xW40xH52cm
CW-929CH	Two-temp	Cold / Hot	ABS	2 liter(cold),2 liter(hot)	D33xW40xH105cm
CW-929CWH	Three-temp	Cold / Warm/Hot	ABS	10 liter(warm),2 liter(cold),2 liter(hot)	D33xW40xH105cm
S-5-2 / S-6-2	Two or temp	Hot/Warm	S.S.	3 liter(cold),16 liter(hot)	D46xW48xH42cm
S-5-3 / S-6-3	Three-temp	Cold/Warm/Hot	S.S.	8 liter(warm),3 liter(cold),16 liter(hot)	D46xW48xH42cm
TPH-689	One-temp	Hot / Ambient	S.S.	5 liter(hot)	D23xW29xH42cm
TPHC-689	Two-temp	Cold/ Hot	S.S.	2.3 liter(cold),5 liter(hot)	D29xW46xH42cm
TPCCH-689	Three temp	Cold / Hot / Ambient	S.S.	2.3 liter(cold),5 liter(hot)	D29xW46xH42cm
TR-5-2	Two-temp	Hot/Warm	S.S.	7.5 liter(warm),5 liter(hot)	D48xW59.5xH59.2cm
TR-5-3	Three-temp	Cold/Warm/Hot	S.S.	7.5 liter(warm),2.3 liter(cold),5 liter(hot)	D48xW59.5xH59.2cm

Water Softener

Fleck 5600 control valve softener system includes

1. Mineral Tank
2. Stainless Jack
3. 3/4" By-Pass
4. C100E Resin
5. 14x34 Brine Tank Assembled
6. Control valve

Option

Item no.	Description
BT-1833	Brine Tank
60041	1" By-Pass
TM-1240A	Acid Washed carbon



F-SD (Separate)



F-SC (Combine)

Part no.	Tank Size	In/Outlet	Resin/L	Capacity	Flow rate/H	Brine Tank
F-SC-5	6x18	1"	5	5700 ft3	350 Liter	55 lbs
F-SC-10	6x35	1"	10	11400 ft3	700 Liter	200 lbs
F-SC-15	7x35	1"	15	17100 ft3	1000 Liter	200 lbs
F-SC-20	8x35	1"	20	22800 ft3	1500 Liter	200 lbs
F-SC-25	9x35	1"	25	28500 ft3	1700 Liter	200 lbs
F-SC-30	10x35	1"	30	34200 ft3	2100 Liter	200 lbs
F-SD-10	6x35	1"	10	5700 ft3	350 Liter	40 lbs
F-SD-15	7x35	1"	15	11400 ft3	700 Liter	175 lbs
F-SD-20	8x35	1"	20	17100 ft3	1000 Liter	175 lbs
F-SD-25	9x35	1"	25	22800 ft3	1500 Liter	250 lbs
F-SD-30	10x35	1"	30	28500 ft3	1700 Liter	250 lbs
F-SD-35	10x40	1"	35	34200 ft3	2100 Liter	250 lbs
F-SD-40	10x47	1"	40	45600 ft3	2800 Liter	400 lbs
F-SD-45	10x54	1"	45	51300 ft3	3200 Liter	400 lbs
F-SD-60	12x52	1"	60	68400 ft3	4000 Liter	400 lbs
F-SD-70	13x54	1"	70	79800 ft3	4800 Liter	400 lbs
F-SD-80	14x47	1"	80	91200 ft3	5200 Liter	400 lbs
F-SD-100-1	14x65	1"	100	114000 ft3	6000 Liter	400 lbs
F-SD-100-2	14x65	1-1/2"	100	114000 ft3	6000 Liter	400 lbs

FRP Vessel Tank

Specification

Pressure vessels are made of high performance composite material with filament winding. All pressure vessels are 100% corrosion resistant. Various thermoplastic liners of polyester, high strength polypropylene, etc. Liner wall thickness available from 0.150" up to 0.300" corresponding to the vessel diameter. Operating pressure 150psi, operating temperature 150F.



Part no	Tank Size	Opening	Base	Part no.	Tank Size	Opening	Base
PG-618	6x18	2.5"	Standard	PG-1652-4T	16*52	4"	Standard
PG-635	6x35	2.5"	Standard	PG-1665-4T	16*65	4"	Standard
PG-735	7x35	2.5"	Standard	PG-1665-4TB	16*65	4"-4"	Tripod
PG-835	8x35	2.5"	Standard	PG-1865-4T	18*65	4"	Standard
PG-935	9x35	2.5"	Standard	PG-1865-4TB	18*65	4"-4"	Tripod
PG-948	9x48	2.5"	Standard	PG-2162-4T	21*62	4"	Standard
PG-1035	10x35	2.5"	Standard	PG-2162-4TB	21*62	4"-4"	Tripod
PG-1054	10x54	2.5"	Standard	PG-2472-4T	24*72	4"	Standard
PG-1248	12x48	2.5"	Standard	PG-2472-4TB	24*72	4"-4"	Tripod
PG-1252	12x52	2.5"	Standard	PG-3072-4T	30*72	4"	Standard
PG-1354	13x54	2.5"	Standard	PG-3072-4TB	30*72	4"-4"	Tripod
PG-1452	14x52	2.5"	Standard	PG-3672-4T	36*72	4"	Standard
PG-1465	14x65	2.5"	Standard	PG-3672-4TB	36*72	4"-4"	Tripod
PG-1652	16x52	2.5"	Standard	PG-1865-6T	18*65	6" FLG	Tripod
PG-1665	16x65	2.5"	Standard	PG-1865-6TB	18*65	6"-6" FLG	Tripod
PG-1054-4T	10x54	4"	Standard	PG-2162-6T	21*62	6" FLG	Tripod
PG-1252-4T	12x52	4"	Standard	PG-2162-6TB	21*62	6"-6" FLG	Tripod
PG-1354-4T	13x54	4"	Standard	PG-2472-6T	24*72	6" FLG	Tripod
PG-1452-4T	14x52	4"	Standard	PG-2472-6TB	24*72	6"-6" FLG	Tripod
PG-1465-4T	14x65	4"	Standard	PG-3072-6T	30*72	6" FLG	Tripod
PG-1465-4TB	14x65	4"-4"	Tripod	PG-3072-6TB	30*72	6"-6" FLG	Tripod
				PG-3672-6T	36*72	6" FLG	Tripod
				PG-3672-6TB	36*72	6"-6" FLG	Tripod
				PG-4272-6TB	42*72	6"-6" FLG	Tripod
				PG-4872-6TB	48*72	6"-6" FLG	Tripod

Multi-media Filtration System

MS full automated Iron and Manganese filtration system.

Eliminate dissolved/deposit of Iron and Manganese, most recommended equipment for preventing metal smell and brown stains.



Underground water/well water may contain Iron and Manganese higher than the limitation. It leads to foul smell for water drinking or industrial application also leaves colored stains on fabrics and utility. Negative influence strongly impacts to food, beverage, dye house, paper manufacturing and alcoholic industries. Usually Manganese greensand will be used for Iron and Manganese removal.

AC full automated Active Carbon Filtration system.

Using high density micro-pore absorbs color and smell of organic compound (e.g. Freon and phenol), to purify water.

Using high density micro-pore, absorb the color and smell of organic compound (e.g. Freon and Phenol) to purify the water to be clean. High efficient control valve with back flow wash function is able to eliminate the contaminant on the carbon surface, to maximize the efficacy.

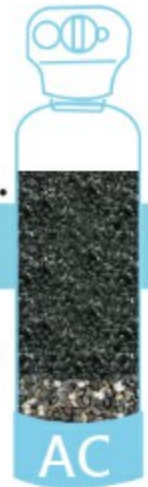

SS full automated Sand Filtration system.

The most economy equipment for suspended material removal

Sand filtration is mainly used for removal dirt and suspended material of underground water/surface water/well water. Dirt and small rocks place the highest proportion of dissolved and in-dissolved elements in water and the most efficient removal way is to block and capture them. Placing different grain size of rock and sand based on natural principle, to form high and low density filter bed, allows capturing the dirt, small rocks and sand, in order to purify the water. The control valve for filtration type can have timer setting function and auto back flow washing to prevent blockage by human error.



• MS/AC/SS

Filtration system-Specification sheet

Tank size/in"	Material/L	In/Outlet
7" x 35"	10	1"
8" x 35"	15	
9" x 35"	20	
10" x 35"	25	
10" x 54"	30	
10" x 54"	45	
12" x 52"	50	
12" x 52"	60	
13" x 54"	70	
13" x 54"	80	
14" x 65"	100	1" / 1 1/2"
16" x 65"	120	

※ Other demands for material over 150L also available to supply.

Full automated Softener Filtration system.

SD double tank series

Most water contains the elements such as Ca, Mg, and Na which result water hardness.

These elements create scale and easily block water pipes and heaters, forming spots on taps and utilities to reduce operation performance. So not easy on cleaning and may cause unnecessary consumption and environmental pollution. Water Softener system can remove the Lime and provide better life quality.

Ion exchange resin (Na⁺) can use sodium to make Ion exchange for Ca, Mg, and Na, and desorbs sodium to reduce the water hardness. To regenerate resin, simply use sodium chloride (Salt) when resin is in saturated situation, and simply use sodium chloride (Salt) to regenerate reduction on resin for future recycling operation. Good quality of control valve is able to make resin with full softening and well regeneration.



• SD-Specification sheet

Part no.	Tank size/in"	Material/L	In/Outlet	Brine Tank
F-SD-10L	7" x 35"	10	1"	100L
F-SD-15L	8" x 35"	15		
F-SD-20L	9" x 35"	20		
F-SD-25L	10" x 35"	25		
F-SD-30L	10" x 54"	30		
F-SD-45L	10" x 54"	45		
F-SD-50L	12" x 52"	50		
F-SD-60L	12" x 52"	60		
F-SD-70L	13" x 54"	70		
F-SD-80L	13" x 54"	80		
F-SD-100L	14" x 65"	100	1" / 1 1/2"	100L / 200L
F-SD-120L	16" x 65"	120		

※ Other demands for material over 150L also available to supply.

Control Valve Types

A. FLECK Control Valve:

- FLECK5600/1600T Timer control valve
 - FLECK 5600/1600M Meter control valve
1. CV5600ST (Softener)
 2. CV5600FT (Filtration)
 3. CV5600SM (Softener)
 4. CV2850ST (Softener)
 5. CV2850FT (Filtration)

B. Binrun Control Valve:

Voltage / frequency	220/50
Regeneration Flow	downflow
Thread type	NPT
Adapter base	2 1/2" with O-ring
Medium	Cold
Distributor pilot	1" plastic
Timer type	12 day
Moter speed	1/30 RPM
Regeneration time	02:00:00 AM

Manual Valve:

C. Multi-port Valve:

1. FWS25 2.5"(In / Out 1")
2. FWS40 4"(In / Out 1-1/2")



Other Components

Part no.	Model	Description
A0231		Brine Valve(BV)
A0231-01		Air Check(J-Tube)
A0224-01		Brine Valve (big) for Cabinet
A0125		By Pass Valve 1" 1"York
A0125-01	TF-13398	By Pass Valve 1" 1"York
A0125-01-1		By Pass Valve 1"-NPT(plastic)
Q0125	AUTO-439	In-out Valve 1"
Q0125-01		In-out Valve 1-1/2"
Q0125-02		In-out Valve 2"
Q0125-03		In-out Valve 3/4"



A 0231



A 0231-01



A 0224-01



A 0125



A 0125-1



A 0125-01



Q 0125



Q 0125-3

Distributors

Top



Bottom



Six Laterals Distributors



Eight Laterals Distributors



Part no.	Model	Description	Tank Size	Tank Opening
Q100-01	H2801	Top distributor 3/4"	7"-14"	2.5" Top
	H2805	Top distributor	7"-14"	2.5" Top
Q0112-02	H2809	Top distributor(High flow)	7"-14"	2.5" Top
	H-182	Top distributor	12"-16"	4" Top
Q0112-01	H5671	Top distributor	14"-36"	4"-4" Top & Bottom
	H2814	Top distributor	30"-36"	4"-4" Top & Bottom
	H2815	Top distributor	36"-48"	4"-4" Top & Bottom
Q0112	H172	Top distributor	36"-42"	6"-6" Flange Top & Bottom

Part no.	Model	Description	Tank Size	Tank Opening
	H173	Top distributor	42"-48"	6"-6" Flange Top & Bottom
Q0102-01	B2038	Bottom distributor 3/4"	7"-14"	2.5" Top
	H2807	Bottom distributor	7"-14"	2.5" Top
	H2810	Bottom distributor(High flow)	7"-14"	2.5" Top

Part no.	Model	Description	Tank Size	Tank Opening
Q0117	HU6260/5688	Six laterals	12"-16"	4" Top
Q0115-01	HU6370/5666	Six laterals	18"-21"	4" Top
Q0116	HU6450/5667	Six laterals	24"	4" Top
Q0117-01	HU6600/10848	Six laterals	30"	4" Top
Q0117-02	HU6700/10849	Six laterals	36"	4" Top
Q0117-03	HU6850/10850	Six laterals	40"	4" Top

Option: Bayonet or Threaded connection

Part no.	Model	Description	Tank Size	Tank Opening
Q0112-03	HD6370	Six laterals	18"-21"	4"-4" Top & Bottom
Q0112-04	HD6450/5670	Six laterals	24"	4"-4" Top & Bottom
Q0112-05	HD6600/11039	Six laterals	30"	4"-4" Top & Bottom
Q0112-06	HD6700/11040	Six laterals	36"	4"-4" Top & Bottom
Q0112-07	HU6850/11041	Six laterals	40"	4"-4" Top & Bottom

Remark: Threaded connection

Part no.	Model	Description	Tank Size	Tank Opening
Q0123-02	HD5672-1	Eight laterals	36"	6"-6" Flange Top & Bottom
Q0123-03	HD5673-1	Eight laterals	42"	6"-6" Flange Top & Bottom
Q0123-01	HD5674-1	Eight laterals	48"	6"-6" Flange Top & Bottom
Q0123-04	HD5675-1	Eight laterals	60"	6"-6" Flange Top & Bottom
Q0123-05	HD5676-1	Eight laterals	63"	6"-6" Flange Top & Bottom

Flow Meter & Tubing

Flow Meter



AQF-600



AQF-700

Part no.	Calibration		Dimension	Connector
	GPM	LPM		
AQF-600-101	0.1-1	0.5-35	center to center 5"	Size 1/2"
AQF-600-102	0.2-2	1-7	5"	1/2"
AQF-600-105	1-5	2-20	5"	1/2"
AQF-600-210	1-10	5-35	6.496"	3/4"
AQF-600-220	2-20	10-70	6.496"	1"

Part no.	Calibration		Dimension	Connector
	GPM	LPM		
AQF-700-440	4-40	15-150	N/A	Size 1-1/2"
AQF-700-460	6-60	25-250	N/A	1-1/2"
AQF-700-101	0.1-1	0.5-3.5	3/8"	
AQF-700-102	0.2-2	1-7	3/8"	
AQF-700-105	0.5-5	2-20	1/2"	
AQF-700-210	1-10	5-35		
AQF-700-220	2-20	10-20	1"	

Polyethylene Tube

Code	Color
B	Blue
O	Orange
Y	Yellow
W	White
N	Natural
BK	Black
R	Red
G	Green
GR	Gray

Maximum Pressure and Temperature

Item no.	#177	#178
Size	1/4"	3/8"
Parameter	6mm	10mm
Pressure	230psi	170psi
Tube Tolerance	+/- 0.1mm-20Fu~+150Fu	
Temperature	(-29C~+66C)	



OTHER BRANDS



Fail!

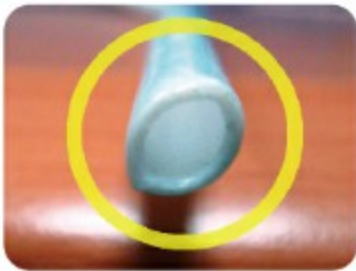

Triwin



UV Sterilizer



#192 1GPM



#195 6GPM



#193 2GPM



#196 12GPM



#194 4GPM



#197 24GPM

Specification:

Model	#192 1GPM	#193 2GPM	#194 4GPM	#195 6GPM	#197 12GPM	#197 24GPM
Flow Rate	0.25 T/hr	0.5 T/hr	1 T/hr	1.5 T/hr	3 T/hr	6 T/hr
Inlet/outlet Part(MNPT)	1/4"	1/4"	1/2"	3/4"	1"	1"
Lamp Sleeve Part#	#198 UVC-S212T5	#199 UVC-D287T5	#200 UVC-D450T5	#201 UVC-D645T5	#202 UVC-D842T5	#202 UVC-D842T5(x2)
Quartz Sleeve Part#	#203 SQ-230*238S	#204 SQ-230*330C	#205 SQ-230*500C	#206 SQ-230*670C	#207 SQ-230*895C	#207 SQ-230*895C(x2)
Ballasts Controller	#208 BT-6W	#208-1 BT-14W	#208-2 BT-24W	#208-3 BT-32W	#208-4 BT-1039W	#208-4 BT-1039W

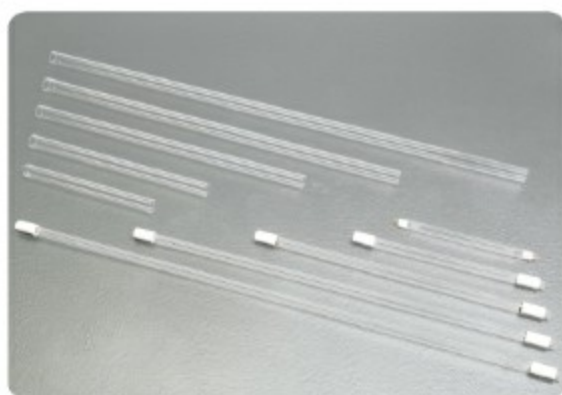

- Lamp failure warning system: LED & Alarm
- Lamp Rated Life: 9000 hours
- Maximum operating pressure: 125 psi
- Electricity: 120 VAC, 220~240VAC & 50 / 60 Hz
- Housing Material: S.S. #304



Water Vending Machine

500 GPD Hydrogen water vending machine



1. Built-in filtration system :

- 1st stage : 10" PP 5U filter
- 2nd stage : 10" GAC filter
- 3rd stage : 10" CTO filter
- 4th stage : 500G RO membrane
- 5th stage : Mineralized filter
- W/booster pump*1, PEM generator*2, Hydrogen pump*1

2. Hydrogen contains : 1000ppb±10%

3. Flow rate : 1.2LPM

4. Monitor : 22.5cm*36cm 、MP4,Resolution:720x480

5. Dimension : W66cm*H185cm*D50cm

New Model Eco-friendly Water Vending Machine



Capacity: 800GPD

Applicable Products: Bottle filling and water gun filling types

Bottle Body Size: Commercial Bottled Water can be accepted.

Bottle Body Capacity: 0.3-20 L

Specification:

1. Electricity: 220V/60Hz/1 Phase
2. Water Pressure Need: 3-5kg/cm² (Must be equipped with a pressurized motor when the inlet pressure is not enough)
3. This machine is made of SUS#304 Stainless Steel and Galvanized steel powder paint and tempered glass.
4. The flow adjustment filling capacity
5. The main body of the machine control independently, LCD display, easy operation
6. Stainless-covered filtration system (basic type)

1st 35L Japanese Resin

2nd 35L Taiwanese Carbon

3rd 35L Far Infrared

4th 10"Hydrogen Water Filter

5th 10" Taiwanese Carbon Filter

6th 10"1u PP filter

7th 4G UV System

8th 10"Mineralized Filter

9th 10"Silver Bamboo Charcoal Filter

10th 10" 1u PP Filter

11th 4G UV System

7. Water source should add with 20"PP filter and UF membrane to ensure water quality.

8. Double faces LED subtitle machine, is the best for advertising

9. Whole surface of the glass, the most conspicuous for corporate image

10. The most conspicuous top sign

11. Two multi-media players of 7 inches are the most convenience way for simple introductions.

12. Fluid contact surface is stainless or PVC which are match to the GMP standard.

13. Water can come out from both right and left that depends on requested.

14. Whole machine LED light with the one week timer, which is eco-friendly and energy saving

15. Filling room and water-adding gun are made of stainless steel

16. Options:

1. 800GPD/1500GPD

2. 11-stage basic filtration system (mentioned above)

3. 55 inches/65 inches multi-media system

4. Hydrogen water system

5. 3L ice water system

Notice:

Option 2 cannot combine with 1, 4 and 5.
Option 1, 4 and 5 can be combined.

Ozone Generator / Pressure Test Machine



Super Ozone Generator

Major function of the healthy, mysterious ozone.

1. Detoxify pesticide of vegetables and fruit.
2. Drinking water.
3. Kitchen cleaning and sanitation.
4. For beauty care, bath and skin care.
5. Family hygiene and cleaning.



#189

Item no.	Part no.	Input voltage	Power consumption	O3 output	Dimension
#189	OWA-200	AC110V/220V, 50/60Hz	50W	200mg/hr(max)	36x26x15cm
#189-1	OWA-350	AC110V/220V, 50/60Hz	55W	350mg/hr(max)	36x26x15cm
#189-2	OWA-500	AC110V/220V, 50/60Hz	60W	500mg/hr(max)	36x26x15cm
#189-3	OWA-1000	AC110V/220V, 50/60Hz	75W	1000mg/hr(max)	36x26x15cm

WATER HAMMER/PRESSURE TEST MACHINE

Model	Dimension	Net Weight
WH-50	50x50x130cm	80kg

FEATURES

To test filter housing/tank pressure with alarm system by simply using hand touch on LCD control panel.

Pressure	5-40kg/cm ²
Pump Flow	Max:2.25 L/min ²
Pressure Setup	LED digital
Time Control:	Stable pressure,time setting,LED digital
Period Control	Adding Pressure---Stable Pressure ---Release Pressure as one period
Max	99999 times
Waste Water recovery	Recovery the testing waste water to re-use
Power	AC220V 1HP 60HZ 1A



100% MADE IN TAIWAN

• High Flow RO Pump



P-135



P-275/P-320



P-500



P-800

SPECIFICATION :

Pump Design	3 Chamber Diaphragm Pump, Self Priming, Capable of Being Run Dry
Motor	permanent magnet
Voltage	24VDC
Liquid Temperature	60°C (140°F) Max.
Certification	CE certified

OUTLET CURVE :

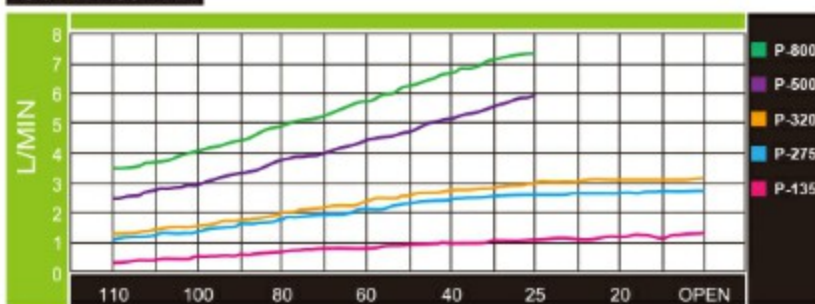

MODEL	110	100	80	60	40	30	20	OPEN	PSI
P-135	0	0.32	0.73	0.87	1.00	1.10	1.15	1.30	OUTLET L/min
P-275	1.10	1.40	1.80	2.10	2.50	2.60	2.70	2.80	
P-320	1.10	1.40	1.80	2.10	2.50	2.60	2.70	2.80	
P-500	2	2.6	3.20	4.20	4.80	5	5.30	5.50	
P-800	4	4.30	5	5.30	5.90	6	6.50	6.50	

Booster Pump Accessories

Item No.	Description
# 214	Solenoid valve DC24V 1/4"
# 215	Solenoid valve DC24V 1/4" (W/quick fitting)
# 216	Solenoid valve 1/4" NPT 220v
# 217	Auto flushing valve 24VDC
# 218	High pressure switch
# 219	Low pressure switch

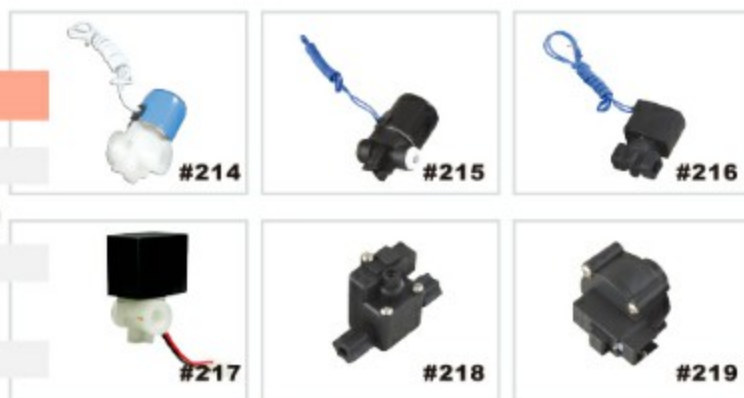

Transformer

#220	Transformer 110V/220V , DC24V , 1.2A
	Transformer 110V/220V , DC29V , 2A
	Transformer 110V/220V , DC24V , 3A
	Transformer 110V/220V , DC24V , 5A



NSF Polypropylene PP Filter Cartridge

- The filter cartridge featured with longer lifespan, more holding capacity, higher removal ratings.

100% Polypropylene

Series : SPP-LL-ZZZ-WX



Specification:

Series No.	SPP-LL-ZZZ-WX
Type	Standard Sediment PP
Micron Ratings	1, 3, 5, 10, 25, 50, 75, 100 Micron
Material of Construction	100% melt-blown micron-denier PP fiber
Length	9-7/8", 10", 20", 30", 40"
Inner Diameter	28mm
Outer Diameter	63mm / 61mm

Features & Benefits

- Three-layers structure cartridge, increasing holding capacity and longer filter services life.
- 100% PP material meets USA FDA standard.
- Micro-Denier melt-blown filtration fiber, high removal ratings.
- Formed by thermal bond without use of any binders and adhesives.
- Certified by NSF Standard 42.

Anti-Bacteria Sediment Polypropylene PP Filter Cartridge

Advanced Nano-PP Technology

Series : AIB-LL-ZZZ-WX



Specification:

Series No.	AIB-LL-ZZZ-WX
Type	Anti-Bacteria PP
Micron Ratings	1, 5, 10, 25, 50 Micron
Material of Construction	100% melt-blown micron-denier PP fiber
Length	9-7/8", 10", 20", 30", 40"
Inner Diameter	28mm
Outer Diameter	63mm / 61mm

Features & Benefits

- Advanced Nano-zinc technology, prevent secondary pollution.
- High performance of Inhibit bacteria growth, such as Staphylococcus aureus, test result: reduction > 99.99%
- Remove contaminant such as suspended substance, particulate and rust efficiency, higher removal ratings and long service life.
- The filter is tested by SGS, high efficiency of anti bacteria.

NSF Grooves PP Filter Cartridge

- The filter cartridge featured with longer lifespan, more holding capacity, higher removal ratings.

100% Polypropylene

Series : GPP-LL-ZZZ-WX



Specification:

Series No.	GPP-LL-ZZZ-WX
Type	Grooves PP
Micron Ratings	1 Micron / 5 Micron
Material of Construction	100% melt-blown micron-denier PP fiber
Length	9- 7/8", 10"
Inner Diameter	28mm
Outer Diameter	63mm / 61mm

Features & Benefits

- Three-layers structure cartridge, increasing holding capacity and longer filter services life.
- Grooves on outside surface, high void volume, and excellent dirt holding capacity.
- No resins, binders or anti static agents to ensure minimal extractables.
- Formed by thermal bond without use of any binders and adhesives.
- Certified by NSF Standard 42.

NSF Slim Grooves PP Filter Cartridge

- The filter cartridge featured with longer lifespan, more holding capacity, higher removal ratings.

100% Polypropylene

Series : BPP-LL-ZZZ-WX



Specification:

Series No.	BPP-LL-ZZZ-WX
Type	Slim Grooves PP
Micron Ratings	1 Micron / 5 Micron
Material of Construction	100% melt-blown micron-denier PP fiber
Length	9- 7/8", 10", 20"
Inner Diameter	28mm
Outer Diameter	63mm / 61mm

Features & Benefits

- Three-layers structure cartridge, increasing holding capacity and longer filter services life.
- Slim grooves on outside surface, holding more contaminant.
- 100% PP material meets USA FDA standard.
- Micro-Denier melt-blown filtration fiber, high removal ratings.
- Formed by thermal bond without use of any binders and adhesives.
- Certified by NSF Standard 42.

Pleated Type Filter Cartridges

Superior-Fine Series Filter Cartridges

- Graded pore structure, increases dirt holding capacity and filtration efficiency
- Easy and safe to incinerate and to dispose
- 100% polypropylene construction
- No surfactant, binder and adhesives
- Provide wide range of filtration applications from 1um to 100um

Pleated-Flow Series Filter Cartridges

- 100% polypropylene construction, suitable for filtration of a wide range of aggressive chemicals and solvents
- All polypropylene parts, polypropylene support layer. With thermal welding to minimise extractable
- Manufactured in a clean room environment (class 10,000)
- Cartridges could be rinse-up to 18 mega ohm-cm in a few minutes

Extra-Flow Series Filter Cartridges

- Absolute rated, pleated melt-blown polypropylene filter cartridges with the new multi-layers depth media
- Effective filtration area for 10 inch cartridges is 0.18m². High flow rate and long service life
- Good gel removal capacity
- Excellent chemical compatibility
- Manufactured in a clean room environment (class 10,000)

Wound-Fine Series Filter Cartridges

- Top-of-the-line cartridges, made by computerised and state-of-the-art equipment to ensure consistent quality
- Graded pore structure for efficient removal of wide range of particle sizes
- Use of inner core cover to prevent fiber migration
- Available in cotton, polypropylene and glass fiber media
- Cartridge lengths from 9.75" to 40" permit rapid installation into filter housing
- Wide chemical compatibility
- Extended core available

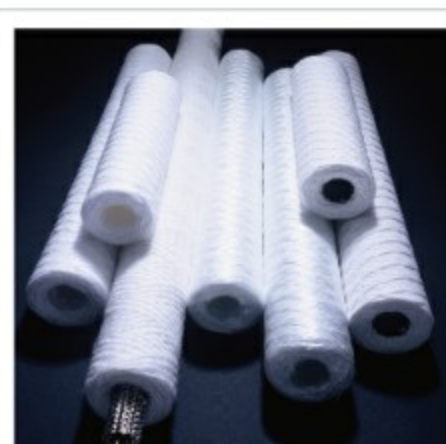

10" PP5u filter



- Multi-layer structure
- Remove sediment, rust, dirt, dust, visible particles
- Maximum Temperature: 50°C
- Maximum Operating Pressure: 125psi
- Services Life: 1500gallon or 3 months recommended (depends on the water quality)

10" GAC filter



- * High Absorptive Capacity
- * Highly Effective Chlorine / Taste / Odor Reduction
- * Certain Organic / Chemicals /VOCs Reduction
- Maximum Temperature : 50°C
- Maximum Operating Pressure: 125psi
- Services Life : 2000gallon or 6 months recommended(Depends on local water quality)

10" CTO filter



- * High Absorptive Capacity
- * Highly Effective Chlorine / Taste / Odor Reduction
- * Certain Organic / Chemicals /VOCs Reduction
- * 5 Micron Nominal Filtration Effective Reduction
- Maximum Temperature : 50°C
- Maximum Operating Pressure: 125psi
- Services Life : 2000gallon or 6 months recommended(Depends on local water quality)

In-line post carbon filter



- * High Absorptive Capacity
- * Highly Effective Chlorine / Taste / Odor Reduction
- * Certain Organic / Chemicals /VOCs Reduction

SERVICE LIFE 1 YEAR OR 1500GAL (5813L)

- Length: 254mm
- Max. Flow rate: .50GPM (1.9LPM)
- Max. Pressure: 125 PSIG (8.6bar)
- Max. Temperature: 100°F (2-38°C)
- Min. Temperature: 35°F (2-38°C)

In-line mineralized filter



This filter improves the quality of clean water by adding necessary for proper human development and health, such as Calcium, Magnesium, Sodium, Potassium and others readily found in many natural water.

- Maximum flow : 3LT/M - 0.8 GPM
- Maximum Pressure : 8.5BAR - 125PSI
- Maximum Temp. : 40°C - 100°F
- Services Life : 6000LT - 1500GAL
- Inlet / Outlet : 1/4:npt
- Size : ø50.5 x 25.4mm - ø1.99" x10"



▪ Color box can be common used for PP/GAC/CTO filter depends on requested.

Multilayer ACT(Ag. Cu. Ti.) Scroll Carbon Block CTO Filter

When **NANO** Technology



Meet **KX** Technology Carbon Filter



Unique Advantages:

- Anti-bacteria, block off 99.9% bacteria.
- Remove heavy metal such as Lead(pb), Mercury(Hg), Chromium(Cr), Cadmium(Cd).
- SGS tested report approved, the specific migration of silver under US FDA standards.
- The filters have been tested by SGS / Intertek / Biotechnology private laboratory.

Medical Grade High-End Technology
Nano- Silver, Copper, Titanium anti-germs cloth

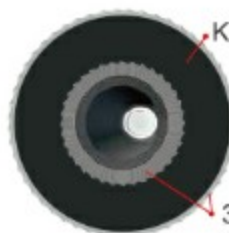

KX Carbon Block
3rd Multilayer
AgCuTi Complex
Thin Film

Ag

Nano Silver

Anti-germs, stinks
Anti-electromagnetic wave.

Cu

Nano Copper

By potential difference to
lower heavy-metal content.

Ti

Titanium Alloy Film

Remote infrared ray light
catalyst (health care function)

NANO Technology specializes in coating technology with PVD vacuum sputtering.

Now the development of ACT complex thin films can be used in potable water filtration anti-bacterial.

KX Technology is providing innovative technologies and custom-designed filtration systems to the collaborative relationships.

All MATRIKX® Extruded Carbon Filters are manufactured using FDA-compliant materials. Meet NSF/ANSI Standards 42.

Multilayer ACT(Ag. Cu. Ti.) Scroll Carbon Block CTO Filter

Unique Features:

- 5µm Nominal Filtration.
- Exceptionally Low Pressure Drop.
- No Release of Carbon Fines.
- Built-in ACT Complex Thin Film Filter.
- Built-in KX CTO Carbon Block, NSF Certified for Material Safety – Standard 42.
- Eliminate the Chlorine Taste and Odor.
- SGS tested proves the specific migration of silver under US FDA standards.
- SGS tested proves effective in Reducing Heavy Metal such as Lead(Pb), Mercury(Hg), Chromium(Cr), Cadmium(Cd).
- Block off bacteria up to 99.9% against Staphylococcus aureus, Escherichia coli, Pneumobacillus, Pseudomonas aeruginosa, Candida albicans



Tested by SGS / Intertek / Private lab



In-ACT



ACT-2066/1066

Specification:

Part No.	ACT-1066	ACT-2066	In-ACT
Size	10"	20"	10" in line
Description	Nano-ACT Carbon Block CTO Filter		
Dimension:	2.5" (OD) x 10" (L)	2.5" (OD) x 20" (L)	2" (OD) x 10" (L)
Carbon Filter	NSF/ANSI Standards 42 , KX Carbon Block Filter Inside		
Inner parts	Multilayer ACT Complex Thin Film Filter Inside		
Nettings	Polyethylene, Silver		
Inner parts	Multilayer ACT Complex Thin Film Filter Inside		
Maxi. Temp.	125°F(51°C)		
Notes	Performance is dependent on influent water quality, flow rates, system design and applications. Recommended to use municipal water.		

The filters have been tested by SGS / Intertek / Biotechnology private laboratory.

Functional Filter

Refilled Filter

Triwin Offers Empty refillable filter cartridges that fit into standard filter housings.

These cartridges can be filled with your filtration media of choice in order to create a filter cartridge that is customized to your specific needs. These cartridges are standard with built-in pre and post filters to keep the media from being washed out of the filter cartridge.



BIO Ceramic in-line filter



Resin in-line filter

Functional Filter



BIO Ceramic Filter



3 in 1 Filter



4 in 1 Filter



5 in 1 Filter



Part No.	Model No.	Description
G0181-02	UDF-10NRE	Refillable Cartridge Housing EP-10, 10"
G0181-04	UDF-BB-10NRE	Refillable Cartridge Housing EP-10BB, 10"
G0181-03	UDF-20NRE	Refillable Cartridge Housing EP-20, 20"
G0181-05	UDF-BB-20NRE	Refillable Cartridge Housing EP-20 BB, 20"
G0181-06	UDF-5NRE	Refillable Cartridge Housing EP-05, 5"

Functional filter



Bamboo Activated Carbon



Mineralized



Energy Potential



Infrared Ray

RO membrane Housing

MH-1812 RO mEmbrane Housing

- The MH-1812 is our best residential series membrane housing, manufactured from the highest quality of FDA graded material.
- The membrane housing is made of polypropylene and come with EPDM double o-ring.

Specification

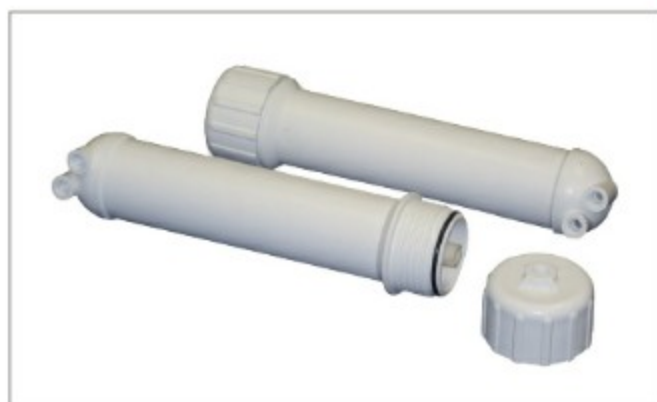

Part no.: H0007
Model: MH-1812
1/8" NPT FEED 1/4" / 1/8" pure 1/8" Drain 1/4" / 1/8"
Max. Burst: 500psi
Cycle Test: 0-150psi , 100,000 times
Max. operating pressure:125psi
Max.operating temp.: 120F(50C)
Feed Water Inlet:1/4" or 1/8"
Pure Water Outlet:1/8"
Drain Water Outlet:1/4" or 1/8"

Stainless Steel Membrane Housing



Materials of construction:

- End Cap ----- 304 SS
- Retaining Ring ----- 304 SS
- Support Straps ----- 304 SS
- Mounting Pads ----- Rubber
- O-ring ----- Buna-N
- Housing Body ----- 304 SS
- Permeate Plug ----- ABS or Nylon
- Cap Screws ----- 304 SS

Benefits:

- Does not warp or weep, like fiberglass
- Resistant to UV rays and sunlight
- Universally accepted material for water systems
- Able to withstand high temperatures
- Capable of supporting process piping
- Lighter than PVC and FRP housings, which make installation easier.

Features:

- Stainless steel 304 connections
- Maximum operating pressure 250 psi (17 bar)
- Stainless steel, High polished exterior
- End entry
- Smooth & sleek look
- Unique design saves both time and money

Part no.	Model	Fit membrane of	Vessel		Water Connection Dimension		
			Diameter	Length	Feed	Pure	Drain
H0012	MH-2521SS	2521x1pc	2.5"	23"	3/8"	3/8"	3/8"
H0013	MH-2540SS	2540x1pc	2.5"	42"	3/8"	3/8"	3/8"
H0014	MH-4021SS	4021x1pc	4"	23"	1/2"	1/2"	1/2"
H0015	MH-4040SS	4040x1pc	4"	42"	1/2"	1/2"	1/2"
H0016	MH-4080SS	4040x2pcs	4"	82"	1/2"	1/2"	1/2"
H0017	MH-8040SS	8040x1pc	8"	42"	1"	1"	1-1/2"
H0018	MH-8080SS	8040x2pcs	8"	82"	1"	1"	1-1/2"
H0019	MH-80120S	8040x3pcs	8"	122"	1"	1"	1-1/2"

The spiral membrane is constructed of one or more membrane envelopes wound around a perforated central tube. The permeate passes through the membrane into the envelope and spirals inward to the central tube for collection.

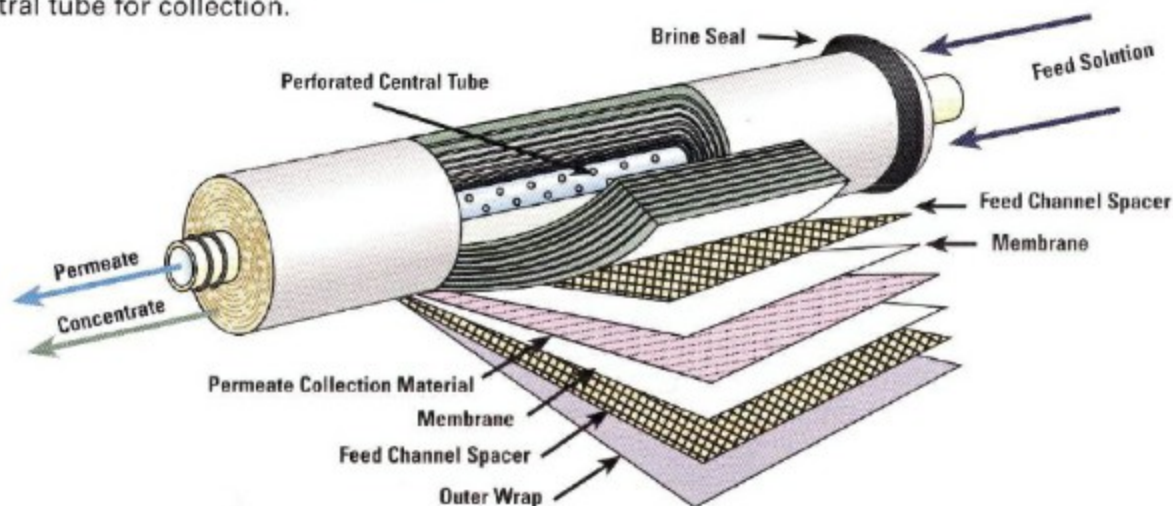

The illustration above represents a simplified spiral-wound membrane element. Recovery can be as high as 90% and systems may be capable of chemical cleaning in place (CIP).

RO Membrane

Dow Filmtec



FILMTEC™

* 25/case 12"x12"x14" 14lbs

* Wet on request

ET-PURE



	Part No.	Model No.	Description
Filmtec	H0093	TW1812-50	50 GPD
	H0094	TW1812-75	75 GPD
	H0092-01	TW1812-100	100 GPD
	H0095	TW30-2521	300 GPD
	Part No.	Model No.	Description
ET-PURE	H0109-01-1	ULP-1812-50	50 GPD
	H0109-01-3AA	ULP-1812-75	75 GPD
	H0109-01-4AA	ULP-2012-100	100 GPD

UF	Part No.	Model No.	Description
	G0182-3-01	UF membrane	50 GPD
Toray	Part No.	Model No.	Description
	H0160	TMG10-4040	200 GPD
	H0161-01	TM710	2400 GPD
	H0160-01	M720-400	10200 GPD
Pentair	Part No.	Model No.	Description
	H0155	TLC-50	50 GPD
	H0156	TLC-75	75 GPD

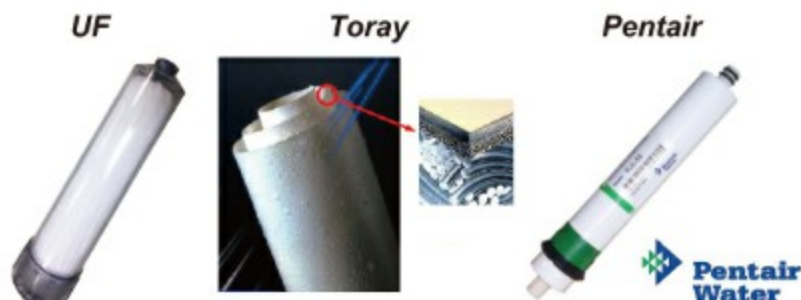

RO membrane&Filter Cartridges



Code Description

- # 1 RO Membrane-Filmtec(50/75/100GPD)
- # 2 RO Membrane-Pentair(50/75/100GPD)
- # 3 RO Membrane-Puretron(400/500/600GPD)
- # 4 RO Membrane-ET-PURE(50/75/100GPD)
- # 7 Spun PP 5u 10"
- # 8 Spun PP 1u 10"
- # 9 GAC carbon. 10" (T-33)
- # 10 UDF (GAC) carbon. 10"
- # 11 CTO carbon block, 10"
- # 12 Ion resin cartridge, 10"

Code Description

- # 13 In-line PP 5u, 10"
- # 14 In-line post carbon, 10"
- # 15 Series PT post carbon, 10"
- # 16 In-line post carbon, 10"- Ominipure
- # 17 In-line Bio ceramic, 10"
- # 18 Ceramic-filter-flat, 10"
- # 19 Series PT in-line pp 5u, 10"
- # 20 Series PT in-line pp 1u, 10"
- # 21 Series PT in-line GAC carbon, 10"
- # 23 Series PT Ion-resin, 10"
- # 24 K type in-line prefilter PP 5u, 10"

Code Description

- # 25 K type in-line Sediment PP 1u, 10"
- # 26 K type in-line GAC carbon, 10"
- # 27 K type in-line Ion resin, 10"
- # 28 Series ET Spun PP 5u, 10"
- # 29 Series ET Spun PP 1u, 10"
- # 30 Series ET GAC carbon, 10"
- # 31 Series ET CTO carbon block, 10"
- # 32 Series HGS Spun PP 5u, 10"
- # 33 Series HGS GAC carbon, 10"
- # 34 Series HGS CTO carbon block, 10"
- # 35 Series HGS Ion resin, 10"

Filters&Housing

FILTER



#36



#37



#38



#39



#40



#41



#46



#47



#48



#49



#50



#51



#52



#53

HOUSING



#55



#56



#57



#58



#59



#60

#61 Dual Color Housing 10"



#62



#63



#64



#65



#66

Code Description

- # 36 Post Mineralized filter, 10"
- # 37 Pleated Sediment Filter 10"
- # 38 String Wound 5u 10"
- # 39 2 in 1 Cartridge (PP 5u+GAC) 10"
- # 40 Big Blue Spun PP 5u 10"
- # 41 Big Blue CTO Carbon Block 10"
- # 46 Spun PP 5u 20"
- # 47 GAC carbon, 20"
- # 48 CTO carbon block, 20"
- # 49 Ion resin, 20"
- # 50 Big Blue Spun PP 5u 20"

Code Description

- # 51 Big blue CTO carbon block, 20"
- # 52 Shower filter-complete set
- # 53 Shower filter-Replacement cartridge
- # 55 RO membrane housing. double O-ring
- # 56 Clear cup. white cap 10" - flat
- # 57 White cup. white cap 10" - flat
- # 58 Clear cup, white cap 10" - Rib
- # 59 White cup, white cap 10" - Rib
- # 60 Double O-ring white cup/cap 10" - flat
- # 61 Double color housing 10" - flat
- # 62 Series HGS housing 10" white

Code Description

- # 63 Big flow clear cup. black cap 10" - Rib, w/pressure release(HGF-1034)
- # 64 Big Blue, blue cup, black cap, 10"-Rib w/pressure release(H-10BB)
- # 65 White Cup, White Cap W/Pressure Release - Rib 20"-3/8"
- # 66 Big blue, blue cup, black cap 20" Rib w/pressure release 1" NPT(H-20BB)

STANDARD FILTER HOUSING (With Ribbed Cap)

Features & Benefits

- Slim design reduces space required for installation without sacrificing capacity
- Available in 5" and 10" lengths
- Optional pressure relief button on inlet side of cap
- Leak-proof seal with top-seated O-ring
- Available with clear or opaque sumps

Standard filter housings are available in either reinforced polypropylene or clear Styrene-Acrylonitrile (SAN) in 5" and 10" lengths. The reinforced polypropylene housing caps are available with 1/4", 3/8", 1/2" or 3/4" NPT connections. Four bosses are molded into every cap for mounting purposes.

For model YT3 series, optional pressure-relief button on the inlet side to relieve pressure inside the housing when changing filter cartridges.



Housing Specifications and Performance Data

Model	Max. Dimensions	Initial ΔP (psi) @ Flow Rate (gpm)
YT1-05CW	120.5 mm X 174.5 mm	1/4" NPT-2 psi @ 3 gpm
YT1-14CW	120.5 mm X 300.0 mm	3/8" NPT-2 psi @ 5 gpm
YT1-05BL	120.5 mm X 174.5 mm	1/4" NPT-2 psi @ 3 gpm
YT1-14BL	120.5 mm X 300.0 mm	1/2" NPT-2 psi @ 5 gpm
YT3-14WW	120.0 mm X 310.0 mm	3/4" NPT-2 psi @ 7 gpm

Materials of Construction

Housing	SAN (Clear) or Polypropylene (Opaque)
Cap	Reinforced Polypropylene
Button Assembly	Stainless Steel, NBR and ABS
O-Ring	NBR
Maximum Temperature	125°F (51.7°C)
Maximum Pressure	Clear 60 psi (4.14 bar), Opaque 100 psi (6.90 bar)

BIG SIZE FILTER HOUSING

Features & Benefits

- Large capacity housing suitable for high flow applications
- 10" and 20" lengths available in opaque and clear
- Pressure relief bleed on inlet side of cap
- Leak-proof seal with top-seated O-ring
- Available with clear or opaque sumps
- Accepts 4-1/2" diameter cartridges

Big Size Filter Housings offer the versatility to meet all of your large-capacity filtration needs, including high-flow and heavy-sediment applications.

The extra large housing allows for greater cartridge capacity, reducing the number of vessels required for high flow-rate applications.

Sumps are constructed of durable reinforced polypropylene for opaque and polycarbonate for clear, and are available in both 10" and 20" lengths.

The high-flow polypropylene (HFPP) cap or ABS cap are available with 3/4", 1", 1-1/4" or 1-1/2" NPT inlet and outlet ports.



Housing Specifications and Performance Data

Model	Max. Dimensions	Initial ΔP (psi) @ Flow Rate (gpm)
YTBL-10BL (3/4")	187.4 mm X 343.15 mm	2 psi @ 15 gpm (0.1bar @ 57 Lpm)
YTBL-10BL (1")	187.4 mm X 343.15 mm	1 psi @ 15 gpm (0.1bar @ 57 Lpm)
YTBL-10BL (1-1/4")	187.4 mm X 343.15 mm	1 psi @ 18 gpm (0.1bar @ 68 Lpm)
YTBL-10BL (1-1/2")	187.4 mm X 343.15 mm	1 psi @ 20 gpm (0.1bar @ 76 Lpm)
YTBL-20BL (3/4")	187.4 mm X 588.30 mm	2 psi @ 15 gpm (0.1bar @ 57 Lpm)
YTBL-20BL (1")	187.4 mm X 588.30 mm	1 psi @ 15 gpm (0.1bar @ 57 Lpm)
YTBL-20BL (1-1/4")	187.4 mm X 588.30 mm	1 psi @ 18 gpm (0.1bar @ 68 Lpm)
YTBL-20BL (1-1/2")	187.4 mm X 588.30 mm	1 psi @ 20 gpm (0.1bar @ 76 Lpm)
YTBL-10CB (1")	187.4 mm X 343.15 mm	1 psi @ 15 gpm (0.1bar @ 57 Lpm)
YTBL-20CB (1")	187.4 mm X 588.30 mm	1 psi @ 15 gpm (0.1bar @ 57 Lpm)

Materials of Construction

YTBL series

YTBL-CB series

Housing	Polypropylene	Polycarbonate
Cap	Polypropylene (HEPP) or ABS	Polypropylene (HEPP) or ABS
Button Assembly	Stainless Steel, NBR and Polypropylene	Stainless Steel, NBR and Polypropylene
O-Ring	NBR	NBR
Maximum Temperature	100°F (37.8°C)	100°F (37.8°C)
Maximum Pressure	YTBL-10BL - 90 psi (6.2 bar) YTBL-20BL - 90 psi (6.2 bar)	YTBL-10CB - 90 psi (6.2 bar) YTBL-20CB - 90 psi (6.2 bar)

RO Bracket / RO Tank NSF

TANK



#72



#73



#74



#75



#76



#77



#78



#79

HOUSING BRACKET



#81



#82



#83



#84



#85



#86



#87



#88



#89



#90

Code Description

- # 72 Series ET-Pure 2.5G tank w/spout
- # 73 RO-122 steel tank. 2.2G
- # 74 TP-12P plastic tank. 2.2G
- # 75 RO-132 Steel tank. 3.2G
- # 76 SS-1800 stainless steel tank. 3.6G
- # 77 TP-19P plastic tank. 5G
- # 78 RO-1070 steel tank. 11G white
- # 79 RO-2000 steel tank, 20G white
- # 81 Faucet bracket BK 01

Code Description

- # 82 Single slim housing bracket. 20" ,FM-20
- # 83 Single high capacity housing bracket, 20" ,FM-25
- # 84 Series CTF double housing bracket ,2I-1
- # 85 Series CTF triple housing bracket ,3I-4
- # 86 Double housing bend down for wall up ,2I-5
- # 87 RO housing bracket ,without pump type ,3I B type
- # 88 RO housing bracket ,with pump type
- # 89 3x20" housing bracket ,RI-9
- # 90 EPRO triple housing bracket ,Plastic

RO Faucet & Accessories

Faucet



#96



#97



#98



#99



#100



#101



#102



#103



#104

Code Description

- #96 Long reach faucet. with 3" shank
- #97 Long reach faucet. with swivel ceramic valve 3" shank
- #98 Long reach faucet. with swivel ceramic valve 3" shank
- #99 Long reach faucet. with swivel ceramic valve 3" shank
- #100 Unique Quarter-forged Brass Faucet

Code Description

- #101 Kitchen-Three in one faucet, Hot/cold/RO(chrom)
- #102 Kitchen-Three in one faucet, Hot/cold/RO(chrom)
- #103 Kitchen-Three in one faucet, Hot/cold/RO(chrom)
- #104 Kitchen-Three in one faucet, Hot/cold/RO(chrom)

Faucet Adapter & accessories



#106



#107



#108



#109



#110



#105



#111



#112



#113



#114



#115

Code Description

- #105 Spout for filtration system-plastic ,PTS-800
- #106 Stand for CTF filtration system ,CTS-500
- #107 Plastic fitting for spout 1/4"PT 1/4:OD
- #108 Universal faucet adapter for FAD -100
- #109 Universal faucet adapter for AD-1.2.3
- #110 Plastic spigot for series ET

Code Description

- #111 Faucet diverter 1/4", PDVB-14CQ
- #112 Faucet diverter FTC-3
- #113 Faucet paneltype. warm
- #114 Faucet paneltype. cold
- #115 Faucet paneltype. hot

RO Accessories - Valves

Feed Water Valves



#142



#143



#144



#145



#146



#147



#149



#150



#151



#152



#153



#154



#155



#156



#157



#158

Tank Valves



#159



#160



#161



#162



#163



#164

Item No. Description

- #142 Feed Water Connector, internal thread 1/4"(1/2" x 1/2") (FT-05)
- #143 Feed Water Connector 3/4" x 3/4") (FT-02)
- #144 Feed Water Connector, internal thread 1/4"(3/4" x 3/4") (FT-07)
- #145 Ball Valve 1/4"PT x 1/4" OD (BV-2)
- #146 Ball Valve 1/4"PT x 3/8" OD (BV-3)
- #147 BSV- 1 Saddle Valve , tube 1/4"
- #149 BSV-6 Saddle Valve, C Clamp tube 1/4"
- #150 Needle Valve 1/4"FIP*1/4"
- #151 Needle Valve 1/4"
- #152 Flow Restrictor, Insert Style 300c.c.

Item No. Description

- #153 Check Valve, Pipe 1/8" Tube 1/4" 40-4-2
- #154 Check Valve, Pipe 1/8" Tube 1/4", w/quick fitting
- #155 Check Valve, Stainless Steel 1/8"*1/8" PT
- #156 Check Valve, 1/4"*1/4"OD , w/quick fitting
- #157 Shut-off Valve Jaco Type 1/4"
- #158 Shut-Off Valve, w/quick fitting 1/4"
- #159 Ball Valve BV-1490-05, Angle 900 Pipe 1/4" Tube 1/4"
- #160 Ball Valve BV-1490-03, Angle 900 Pipe 1/4" Tube 1/4"
- #161 Ball Valve BV-1400-03, P.V.C. Female 1/4"
- #162 Manual flushing valve w/ flow restrictor 300-700c.c.
- #163 Tank Ball Valve BV-1490-SMG 1/4"x1/4"
- #164 Tank Ball Valve PR-CV1344 1/4"x1/4"



Jaco Fitting



#117



#118



#119



#120



#121



#122



#123



#124



#125



#126



#127

Code	Description	Pipe	Tube
#117	Male Connector 10-4-4	1/4"	
#117-1	Male Connector 10-4-2	1/8"	1/4"
#117-2	Male Connector 10-4-6	3/8"	1/4"
#117-3	Male Connector 10-6-4	1/4"	3/8"
#117-4	Male Connector 10-6-6	3/8"	3/8"
#118	Union Connector 15-4-4	1/4"	1/4"-1/2"
#118-1	Union Connector 15-6-4	1/4"	3/8"
#118-2	Union Connector 15-6-6	3/8"	3/8"-1/4"
#119	Bulkhead Union Connector 20-4-T		1/4"
#119-1	Bulkhead Union Connector 20-6		3/8"
#120	Male Elbow 40-4-2	1/8"	1/4"
#120-1	Male Elbow 40-4-4	1/4"	1/4"
#120-2	Male Elbow 40-4-6	3/8"	1/4"
#120-3	Male Elbow 40-6-4	1/4"	3/8"
#120-4	Male Elbow 40-6-6	3/8"	3/8"

Code	Description	Pipe	Tube
#121	Male Branch Tee 60-4-4	1/4"	1/4"
#121-1	Male Branch Tee 60-6-4	1/4"	3/8"
#121-2	Male Branch Tee 60-6-6	3/8"	3/8"
#122	Union Tee 70-4-T		1/4"
#122-1	Union Tee 70-6-T		3/8"
#123	Male Run Tee 75-4-4	1/4"	1/4"
#123-1	Male Run Tee 75-4-2	1/8"	1/4"
#123-2	Male Run Tee 75-6-6	3/8"	3/8"
#124	Nipple N-14	1/4"	
#124-1	Nipple N-38	3/8"	
#124-2	Nipple N-12	1/2"	
#124-3	Nipple	3/8"-1/4"	
#125	Special Connector 80-4-6 for Pressure Gauge	3/8"x1/8"x1/4"	
#126	Tube Insert TC-2		1/4"
#127	Tube Insert TC-3		3/8"

Fittings- Quick

Quick Fitting



#128



#129



#130



#131



#132



#133



#134



#135



#136



#137



#138



#139



#140



#141



Code	Description	Pipe	Tube	Code	Description	Pipe	Tube
#128	Male Connector, MC0402	1/8"	1/4"	#133-1	Male Elbow, ME0404	1/4"	1/4"
#128-1	Male Connector, MC0404	1/4"	1/4"	#133-2	Male Elbow, ME0406	3/8"	1/4"
#128-2	Male Connector, MC0406	3/8"	1/4"	#133-3	Male Elbow, ME0604	1/4"	3/8"
#128-3	Male Connector, MC0604	1/4"	3/8"	#133-4	Male Elbow, ME0606	3/8"	3/8"
#128-4	Male Connector, MC0606	3/8"	3/8"	#133-5	Male Elbow, ME0608	1/2"	3/8"
#128-5	Male Connector, MC0607	1/2"	3/8"	#134	Union Elbow, UE0404	1/4"	1/4"
#129	Union Connector, UC0404	1/4"	1/4"	#134-1	Union Elbow, UE0604	1/4"	3/8"
#129-1	Union Connector, UC0604	1/4"	3/8"	#134-2	Union Elbow, UE0606	3/8"	3/8"
#129-2	Union Connector, UC0606	3/8"	3/8"	#135	Stem Elbow, SE0404	1/4"	1/4"
#130	Bulkhead Union, BU0404	1/4"	1/4"	#135-1	Stem Elbow, SE0406	3/8"	1/4"
#130-1	Bulkhead Union, BU0406	3/8"	1/4"	#135-2	Stem Elbow, SE0606	3/8"	3/8"
#130-2	Bulkhead Union, BU0606	3/8"	3/8"	#136	Stem Run Tee, SRT0404	1/4"x1/4"x1/4"	
#131	Stem Adapter, SA0404	1/4"	1/4"	#137	Union Tee, UT0404	1/4"x1/4"x1/4"	
#131-1	Stem Adapter, SA0604	1/4"	3/8"	#137-1	Union Tee, UT0604	1/4"x3/8"x1/4"	
#131-2	Stem Adapter, SA0606	3/8"	3/8"	#137-2	Union Tee, UT0606	3/8"x3/8"x3/8"	
#132	Female Adapter, FA04-716	7/16"	1/4"	#138	Male Branch Tee, MBT0404	1/4"x1/4"x1/4"	
#132-1	Female Adapter, FA06-716	7/16"	3/8"	#138-1	Male Branch Tee, MBT0606	3/8"x3/8"x3/8"	
#132-2	Female Adapter, FA-0404	1/4"	1/4"	#139	Stem Branch Tee, SBT0404	1/4"x1/4"x1/4"	
#133	Male Elbow, ME0402	1/8"	1/4"	#140	Male Run Tee, MRT0404	1/4"x1/4"x1/4"	
				#141	Two Way Divider, TWD0404	1/4"X1/4"X1/4"	

Other Accessories

Flow Control



#165



#166



#167



#168



#169

CLIP



#170



#171



#172



#173



#174



#175



#176

Accessories

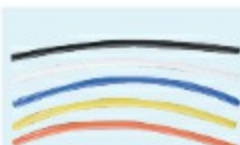

#177



#178



#179



#180



#181



#182



#183



#184



#185



#186

Item No. Description

- # 165 Water Pressure Regulator PR-1414(1/4"x1/4")
- # 166 Flow Restrictor Jaco Type, 300cc/400cc/450cc
- # 167 Flow Restrictor Quick Fitting Type, 300cc/350/420cc/550cc/850cc
- # 168 Drain Clamp 1/4" Jaco Type
- # 169 Drain Clamp with Quick Fitting Type 1/4"
- # 170 C-2000WA 2" In-Line Filter Clip
- # 171 C-2500WA 2-1/2" Membrane Housing Clip
- # 172 DC-2000W-KF 2"x2" Double In-Line Filter Clip
- # 173 DC-2500WA 2-1/2"x 2" Double Filter Clip
- # 174 DC-3000W-KF 2-1/2"x2-1/2" Double Filter Clip
- # 175 10" Housing Wrench D4
- # 176 20" Housing Wrench WR-ST4

Item No. Description

- # 177 PE Tube 1/4" TPE14W
- # 178 PE Tube 3/8" TPE38W
- # 179 PH Tester PH-600
- # 180 TDS Meter 0-2999ppm(CE)
- # 181 Tank Pressure Gauge TPG-300
- # 182 Pressure Gauge
- # 183 Water Quality Electrolyzer 110/2220V
- # 184 Micron Computer Controller
- # 185 Micron Computer Controller W/TDS Meter
- # 186 Adjustable Flow Restrictor

NSF Pressure Limiting Valve

PRESSURE LIMITING VALVE (PLV) NSF/ Watermark Certified !!



Reducing pressure from inlet water to prevent damage from water hammer

Suitable for RO systems, Water Purifiers, Water Coolers and washing machine...etc.



Part No.	Tube (O.D.)	Outlet Pressure (psi)
FPV0104	1/4"	40, 50, 60, 70, 80, 125
FPV0308	3/8"	40, 50, 60, 70, 80, 125

Features & Benefits

- This valve is applicable for high pressure water system to protect components.
- Reducing water hammer by using this pressure limiting valve.
- Different pressure ratio setting for options to suit different application.
- Quick fitting connector, easy installation.

Specification:

Flow Rate	7.5LPM at 100psi inlet pressure
Outlet Pressure	options from 40, 50, 60, 70, 80, 125psi $\pm 10\%$ at 150psi.
Maximum Inlet Pressure	230PSI
Working Temperature	4°C ~ 40°C

Mechanical Leakage Detector

Widely Application for water purifier, water cooler, washing machine, etc.



Features:

- leakage security
- Lower cost, higher prevention
- Easy installation
- Easy to change the replaced sponge
- Easily and quickly prevent leaking from the system

Application:

1. Any kind of RO or filtration System
2. Water Cooler
3. Washing Machine
4. Other Home Appliance, require water leakage prevention

Leakage Security-

Lower cost, higher prevention

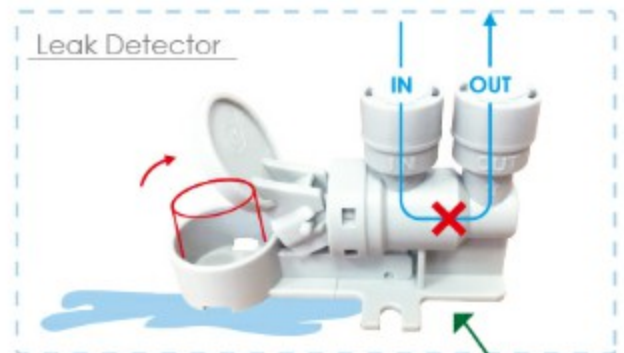

Application:
The water leakage detector is suitable for our water tray for RO system to prevent any leaking

Assembling instruction of Water hammer

• What is Water Hammer?

Hydraulic shock (colloquial: water hammer) means the water flows in the long pipeline. At this time, if the valve downstream of the pipeline is quickly closed, the flow of the water flow has inertia, so the inertia of the water flow continues to push forward, causing the pressure in the pipe to rise rapidly, causing the pipeline to be damaged.

Standard assembling

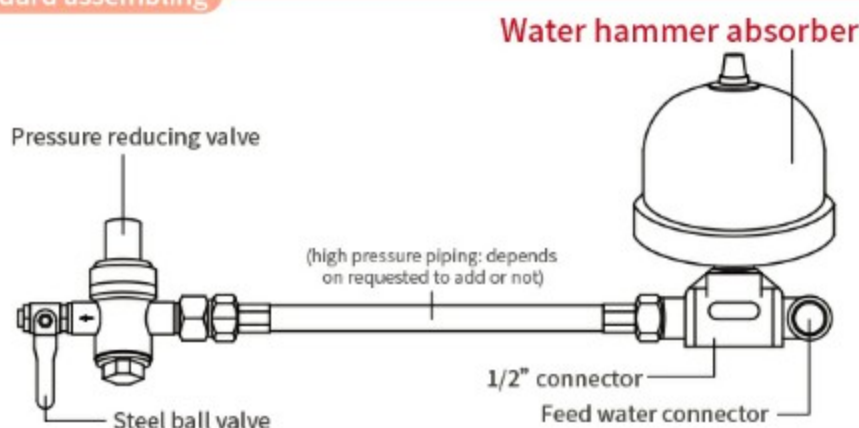

Water Misting System

- The Ideal of gardens, greenhouses, farms, fishpond, factory, schools, shopping malls, restaurants, shops, parks, playgrounds, zoos, markets and outdoor activities

Features:

- Decrease Environment at Temperature
- Environment Humidity Adjustment
- Reduce dust & pollen from the air
- Advertising and gardening
- Beautify Environment Atmosphere
- The best decorating idea for shopping malls, restaurants and parks
- Compact Size
- Easy Installation and Operation

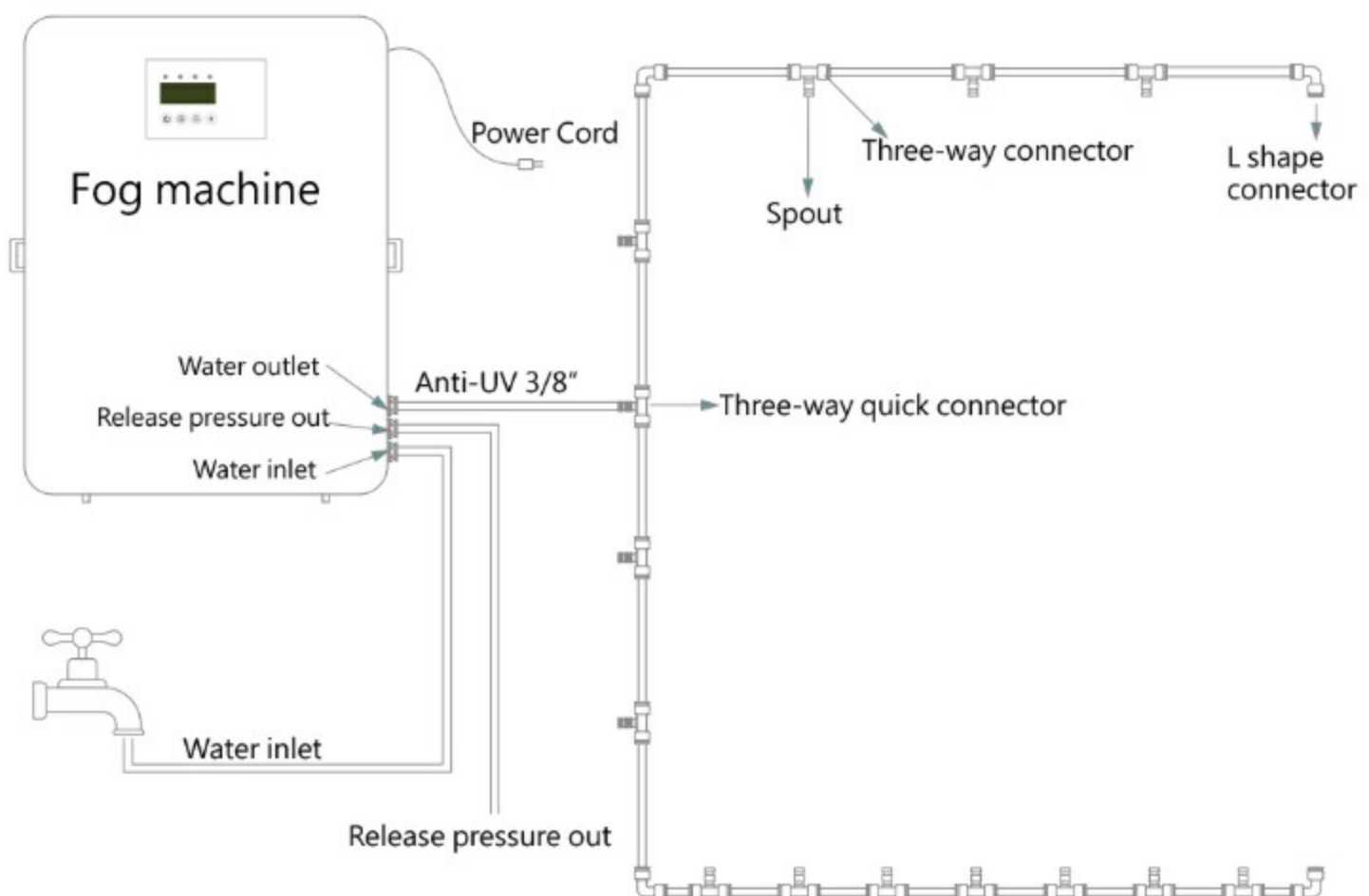

Specification

Model No.	TR-1020
Power	AC 110V~240V, 50/60Hz
Accessories	1. Metal Mist Nozzles * 15pcs 2. Anti-UV PE Tube * 15 meter 3. Tube Cutter * 1pc
Option	2.5 Gallon storage tank is upon request
Dimension	W28*D12*H41cm



Shining Ion Shower

The activated carbon fiber filter

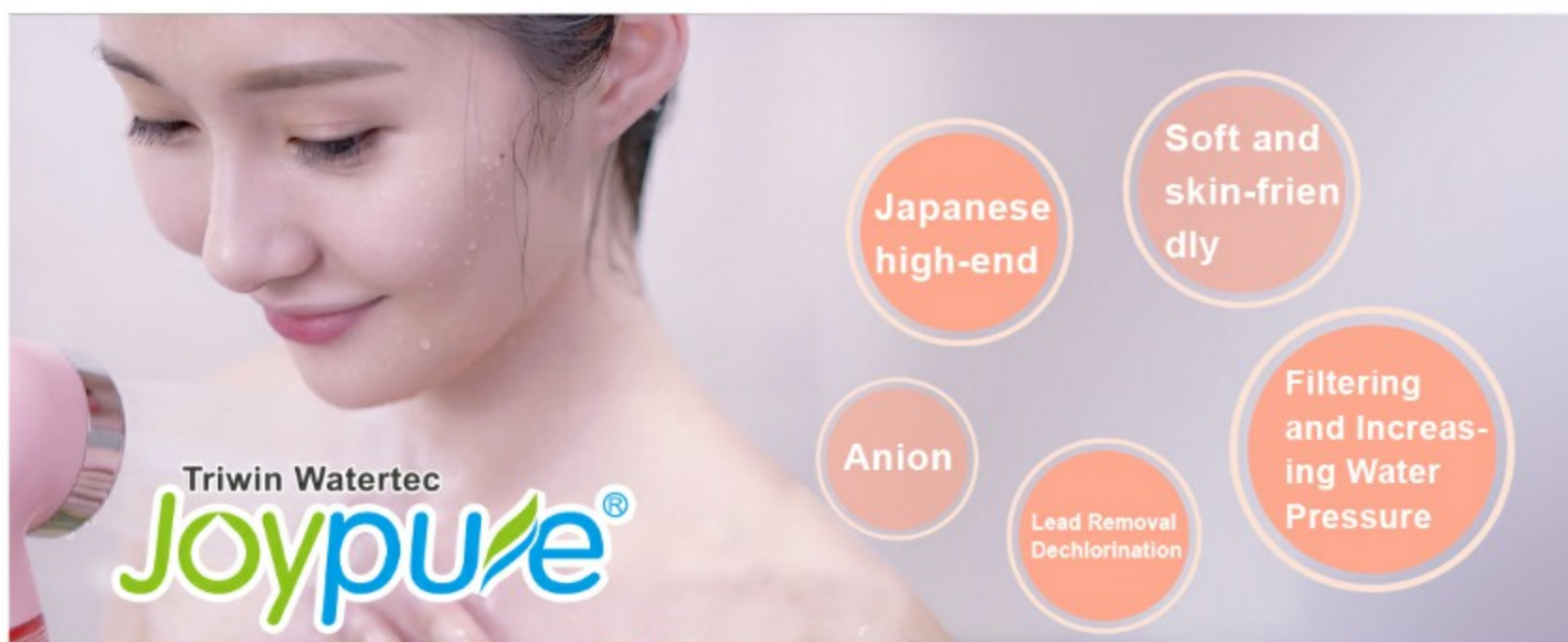

Specification

The Product Name :

Joypure Shining Ion Shower

Product Size : Ø58 x 265mm

Operating Temperature: 0~60°C

Effective Water Purification: 24,000L

Housing Material: ABSResin

Filter Material:

ACFActivated Carbon Fiber Non-woven Fabric

Colour:

■ S0044-12-01AC

■ S0044-12-01AB

■ S0044-12-01AA



#S0044-12-02AA

Slip-resistant Design

Partial anti-slip and roughening, non-slip design makes it better

The Standard Interface

The thread groove is visible with its standard interface which is commonly used, making life easier

Unique Drop-shaped Alignment

Prevent thread damage caused by turning it too tight
Easily replace the filter

The Special Shower Nozzle

Patented water pressure control, the water output speed is 4 times that of ordinary showers, and water saving is 30%.
Smooth water which can produce negative ions

ACF Tap Water Purifier

(Tap water / Clean water / Water Conservation)

Triwin Watertec
Joypure®



Cooking
Delicious
and tasty



Washing
Vegetables
and Fruits
Clean
and secure



Cleaning
the Face
Gentle
and safe



You need at least two tap water purifiers

Highly Dense Multi-layer Filtration

Absorbs foul odors, abnormal colors and improves taste

- 1** 304 Stainless Steel Filter
Removes impurities and iron filings
- 2** Japanese Carbon Fiber
Antibacterial, absorbs foul odors, abnormal colors
- 3** 304 Stainless steel filter
Removes impurities and iron filings

Purified water, sweet taste A cup of healthy water

Filtration Layers

Remove Bad smells, Abnormal Colors and Improves Taste
Filter Sediment, Rust, and Adsorb Residual Chlorine

#S0090-01-02AA

1~5μm

Filtration Layers Filter Impurities Accurately
Filter sediment, rust, and adsorb residual chlorine

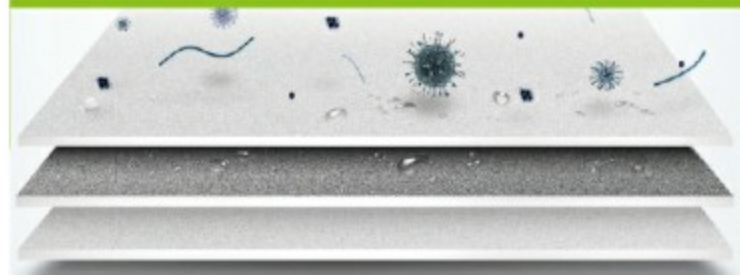

J6002 Joypure ACF Tap Water Purifier (Tap water / Clean water)



The Product number : J6002
Product Size : 148 x 60 x 110mm
Filtration Accuracy : 1~5Micron
Filtration Speed : 1.0~3L/min
Capacity : 1,200L
Handle: Tap water / Clean water
Suitable Water Pressure : 1.5~3kg/cm²
Suitable Water Temperature : 5~38°C
Applicable Tap : The outlet diameter 15-24mm and length of the faucet ≥15mm

J6001 Joypure ACF Tap Water Purifier (Tap water / Clean water / Water Conservation)



The Product number : J6001
Product Size : 148 x 60 x 110mm
Filtration Accuracy : 1~5micron
Filtration Speed : 1.0~3L/min
Filter Life-span : 1,200L
Handle: Tap water / Clean water / Water Conservation
Suitable Water Pressure : 1.5~3kg/cm²
Suitable Water Temperature : 5~38°C
Applicable Tap : The outlet diameter is 15-24mm and length of the faucet is ≥15mm



Japan ACF water filter pitcher of large capacity



Japan ACF (Activated Carbon Fiber)

ACF has been proven that its adsorption is 10-12 times better than other carbon filters.

This means that more contaminants will be eliminated from your water to protect you and your family's health.



#S0090-03-02AA

The filter as the key to good water

—ACF (Activated Carbon Fibers).

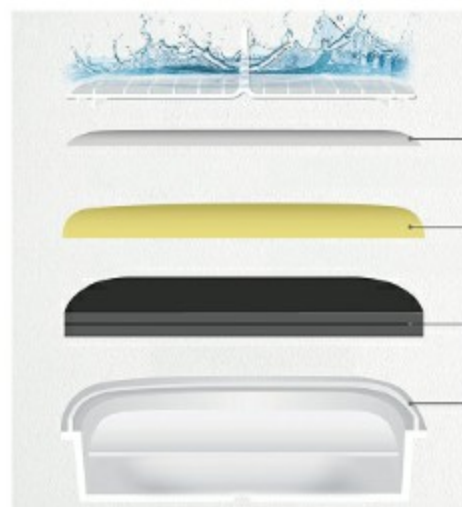

4 stage filtration

Pre-sediment filter:

remove red rust, sediment and other suspended substances in water.

Softener resin filter:

effectively reduce water hardness, scale, and heavy metal help to avoid water scale.

Japan ACF filter:

effectively reduces residual chlorine, benzene, phenol and other organic contaminants causing carcinogens, improve water taste and odor.

Post filter:

further reduce particulate impurities being leaked from front filters

Model No. : CF-7210

Product Name: Japan ACF Water Filter Pitcher

Dimension: 105 X 200 X 275mm

Product includes: Pitcher X 1, Filter X 1

Capacity: 1.8L

Inlet water: Tap water

Filter life-span: 453L

Color: ☒ S0090-03-01AB ☒ S0090-03-01AC ☐ S0090-03-01AD

Portable Water Filter CF-7000

Material with high quality

Flow speed, save time

Flow rate 1.3L/per minute

"Straight out from the tap. Drink directly"



Model No. : CF-7000

Product: Portable Water Filter cup

Dimension: 124x124x115mm

Product includes: water filter cup X 1, filter X 1

Temperature for use and storage: 5-40°C

Inlet water: tap water Average flow rate: 1L/min

Filter life-span: 568L

Color: ☒ S0090-02-01AA ☒ S0090-02-01AC ☒ S0090-02-01AB

The filter as the key to good water

— ACF (Activated Carbon Fibers). Generally, tap water with chlorine is an oxidant which will produce carcinogens or affect your health in long-term. Using ACF to ensure healthy drinking water for daily life.



#S0090-02-02AA

We really want to drink refreshing stream water and dare not drink when participating in outdoor activities

Straw Water Filter

Multi-stage Water Filtration S01 Outdoor Water Filter



- ③ Japanese Activated Carbon Fiber
The filtration capacity is 6-8 times that of general activated carbon which can effectively remove odor, color and the like.
- ② Ultrafiltration Membrane Filter
The filtration accuracy is 0.05 micron which can efficiently filter microorganisms and bacteria in water.
- ① PP Filter
With a filtration accuracy of 5 microns, it can filter particulate impurities such as sediment and rust in rivers and lakes.

The magic of purifying



The Product number: S01

Product Name: Joypure Outdoor Straw Water Filter

Product Size : Ø30.5 x 168mm

Filtration Accuracy: 0.05 micron

Capacity: 1000L

Filtration Speed: 0.5ml/min

Part No. #S0090-04-01AA

When climbing outdoors, you'd better have a small outdoor straw water filter.

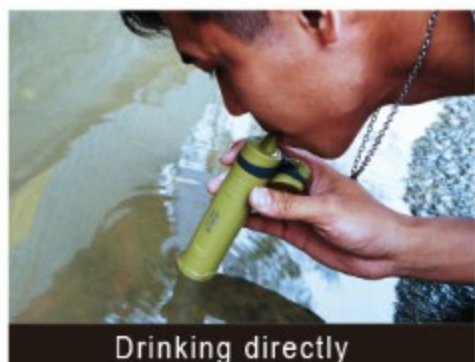

Drinking directly



Drinking with a water bottle



Each Joypure Outdoor Straw Water Filter can filter 1000 liters of water.



It makes drinking water from river and lake become possible by removing at least 99.9999% of bacteria in water, including *Escherichia coli*, *Campylobacter*, *Vibrio cholerae*, *Pseudomonas aeruginosa*, *Shigella* and *Salmonella*, and at least 99.9% of aquatic parasitic protozoa, including *Giardia lamblia*, *Cryptosporidium parvum*, and *Entamoeba histolytica* (but not including heavy metals) through hollow fiber membranes.



Smart Touch
Innovation



Sparkling
Water Cooler



RO Pure Water



Boiling
&
Chilled
Water



TRIWIN WATERTEC CO.,LTD.

NO.3, Lane 45, Section 3, Dafu Rd., Tanzih District, Taichung City 427, Taiwan (R.O.C)

Tel:886-4-25311188 Fax:886-4-25310606

E-mail:sales@triwin.com.tw

<http://www.triwin.com.tw> <http://www.triwin.us>



www.triwinwater.com